

# TOWN DIRECTORY

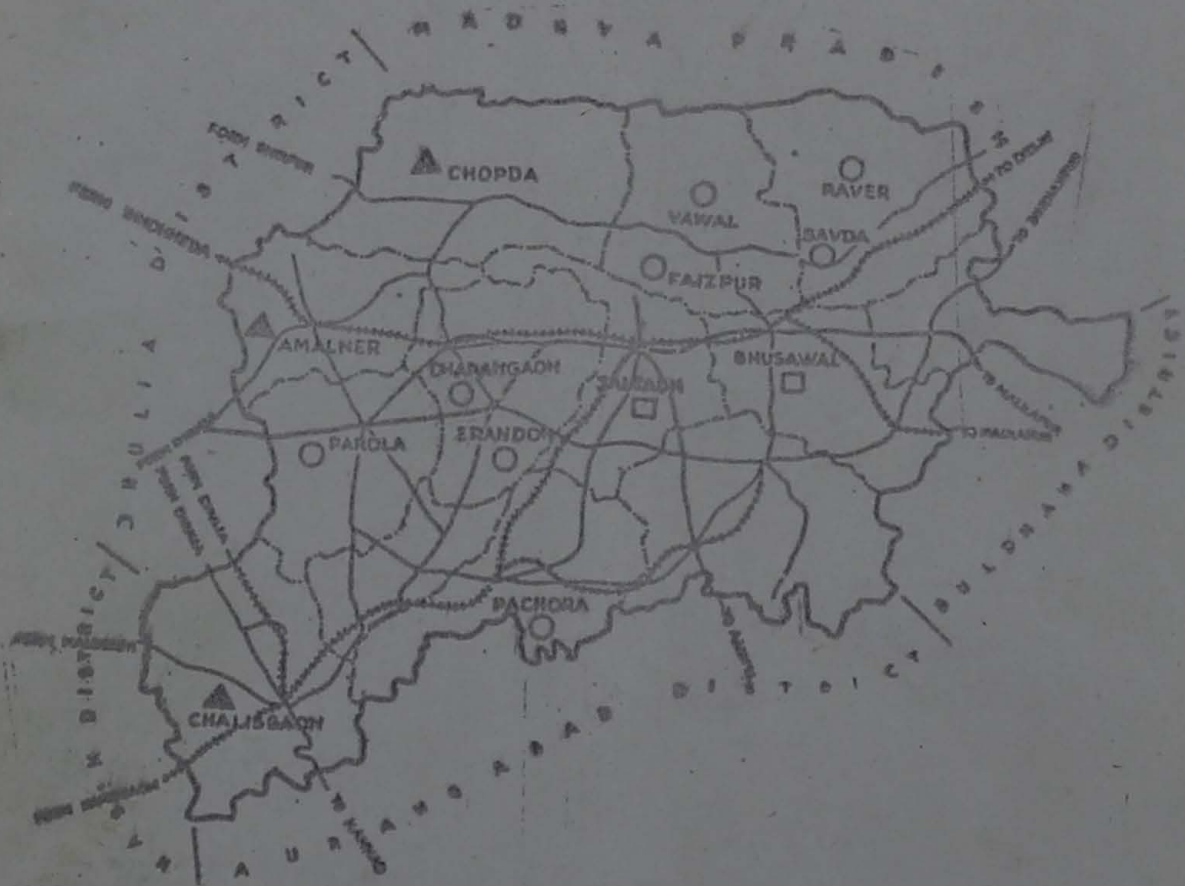

Σ. 2315k

Mo. 16

Σ. 2315k  
MO. 16  
201800

1983

## DISTRICT JALGAON

XVI

TOWN PLANNING AND  
VALUATION DEPT.

MAHARASHTRA STATE  
URBAN RESEARCH CELL

PUNE

TOWN DIRECTORY

VOL. XX

AURANGABAD DISTRICT 1985

	<u>C O N T E N T S</u>	<u>PAGE</u>
00	Introduction	i - iii
00	Aurangabad District. At a Glance	iv - vii
00	<u>MUNICIPAL COUNCILS</u> -	
	* Aurangabad	1 - 20
	* Gangapur	21 - 36
	* Kannad	37 - 53
	* Khuldabad	54 - 67
	* Paithan	68 - 81
	* Vaijapur	82 - 95
- 000 -		
00	<u>M A P S</u> -	
	* Map of Maharashtra State showing position of Aurangabad District.	viii
	* Map showing location of Municipal Councils in Aurangabad District.	ix

Map showing the existing  
& proposed land-use of  
Municipal Council.

O Aurangabad	...	...	x & xi
O Gangapur.	...	...	xii & xiii
O - Kannad	...	...	xiv & xv
O Khuldabad	...	...	xvi & xvii
O Paithan	...	...	xviii & xix
O Vaijapur	...	...	xx & xxi

- 000 -

Published by  
The Dy. Director of Town Planning,  
Urban Research Cell,  
Pune

- 000 -

## INTRODUCTION

### I. General -

1. Maharashtra is the most urbanised State in India with a proportion of urban population of 31.2% as against the national average of 19.9% as per 1971 Census. Final results of 1981 Census are now published which indicate that urbanisation in the State is 35.03%.

2. As per 1981 population Census and subsequent to the merging of 11 Municipal Councils and 14 Non-Municipal Areas in the newly constituted ~~of~~ 6 Municipal Corporations and the establishment of New Municipal Councils by merging therein 4 Non-Municipal Areas <sup>and Revenue villages</sup> there are now 11 Municipal Corporations, 216 Municipal Councils, 7 Cantonments and 57 Non-Municipal Areas making the total of 291 Urban Areas in Maharashtra State. Of the total 216 Municipal Councils, 22 are 'A' Class, 44 are 'B' Class, 144 are 'C' Class and 6 are Hill Station Municipal Councils.

3. Towns in Maharashtra are at different levels of development. They differ from one another in several respects. Their regional settings, functional characteristics, economic base, infrastructural development, per capita income and expenditure, present a heterogeneous picture. Hence, various measures are adopted to achieve a balanced development.

### II. Object and Scope :

1. The Registrar General of Census and various other Agencies present the urban statistics in different forms. However, we have compiled the information from the available Census Publications, Municipal Year Book

(ii)

published by the Directorate of Economics and Statistics, the District Gazetteer and the Development Plan reports prepared for each of the towns by this Department. While compiling the information for a town, it is observed that reference period varies from one source to another. Hence, such a compiled information in a precise form is brought up-to-date to a specific reference year by contacting the concerned authorities of the town.

2. Such a townwise information for the towns in a particular district is being published by the Urban Research Cell of the Town Planning & Valuation Deptt., Maharashtra State, Pune. Uptill now the Town Directories for 19 Districts in the State have been published and circulated to various Agencies.

3. Present Town Directory (Volume No. XX) relates to newly bifurcated Aurangabad District. There are 6 Municipal Towns in the district viz. (i) Aurangabad, (ii) Gangapur, (iii) Kannad, (iv) Khuldabad, (v) Paithan & (vi) Vaijapur. Of these towns (i) Aurangabad had "A" class Municipal Council while remaining towns have "C" class Municipal Councils. In the following pages, information regarding each of the above Municipal towns has been presented separately in respect of different items relating to the latest available year. Since the data for the year 1981-82 have been collected for their inclusion in the Town Directories of the above mentioned Municipal Councils eventhough Aurangabad Municipal Corporation has now been established in December, 1982 the data pertaining to old Aurangabad Municipal Council have been presented therein in Town Directory for Aurangabad.

(iii)

4. Similar Volumes of other Districts in Maharashtra will be issued in due course. However, to be really useful, Town Directory will have to be up-dated periodically. If the idea of compiling and presenting such a Town Directory is appreciated and found useful, the same would be up-dated accordingly.

\*\*\*\*\*

AURANGABAD DISTRICT AT A GLANCE

Sr. No.	Item	Unit	Description
1.	2.	3.	4.

1) LOCATION

1.1	Latitude	Degree	19°18' & 20°40' N
1.2	Longitude	"	74°40' & 76°40' E

2) CLIMATE

2.1	Rainfall	MM	686
2.2	Temperature		
	a) Maximum	Centigrade	41.8
	b) Minimum	"	11.4

3) AREA AND POPULATION (1981)

3.1	Total Area	Sq. Km.	16,305
3.2	Number of Villages (1971)	No.	1975
3.3	Number of Towns	"	10
3.4	Total Population (1981 Census).	"	24,33,420
3.5	Total Rural Population/Percentage to Total Population.	No./%	18,95,885 77.91
3.6	Total Urban Population/Percentage to Total Population.	"	5,37,535 22.09
3.7	Density of Population.	Per Sq. Km	149
3.8	Sex Ratio	Females per 1000 males.	947
3.9	Total Workers	No.	11,02,828
3.10	Percentage of Total Workers to Total Population	%	45.32

4) AGRICULTURE (1978-79)

4.1	Total Geographical Area.	'00' Ha	16272
4.2	Area under Forest	"	820
4.3	Area not available for cultivation.	"	1009
4.4	Other Uncultivated land excluding fallow land.	"	1046
4.5	Fallow Land	"	1257

( v )

=====

1.	2.	3.	4.
----	----	----	----

=====

4.6	Net area sown	'00' Hect.	12141
4.7	Area sown more than once.	"	1304
4.8	Gross Cropped Area	"	13445
4.9	Total Net Area Irrigated.	"	1421
4.10	Percentage of Net Area Irrigated to Net area sown.	%	11.70
4.11	Major Crops of the District.	Name	Rice, Wheat, Jawar, Tur, sugar-cane, cotton, Bajra, Groundnut.

5) INDUSTRIES (1980)

5.1	Total Number of Working Factories.	No.	229
5.2	Average Daily Employment.	'000'	21
5.3	Total Number of Registered Factories.	"	255
5.4	Total Workers in Registered Factories.	"	20885
5.5	Number of Workers employed in Registered Factories per lakh of Population (1981).	"	858.25

6) CO-OPERATION (As on 30.6.1981).

6.1	Total Number of co-operative Societies.	No.	2166
6.2	Total Number of Members.	'000'	500
6.3	Total Loans advanced (by Agril. Credit Societies).	Crores of Rs.	22

7) MEDICAL & PUBLIC HEALTH (1979-80)

7.1	Hospitals	No.	8
7.2	Dispensaries	"	50
7.3	Primary Health Centres	"	20
7.4	Number of Beds in Hospitals and Dispensaries.	"	1298



1.	2.	3.	4.
7.5	Beds per lakh of population(1981)	No.	53.34
7.6	Birth Rate (1980)	Per '000'	16.1
7.7	Death Rate.	"	4.5
7.8	Veterinary Hospitals & Dispensaries.	No.	Hospitals-3 Dispensaries-11

8) EDUCATION(1977-78)

8.1	Primary Education		
	a)Institutions	No.	2220
	b)Students	'000'	279
8.2	Secondary Education		
	a)Institutions	No.	227
	b)Students	'000'	82
8.3	Higher Education		
	a)Institutions	No.	46
	b)Students	'000'	23
8.4	Percentage of School-going children.		
	a)In age-group of 6-11 years.	%	N.A.
	b)In age-group of 11-14 years.	%	N.A.
8.5	Percentage of Literacy (1981).		
	a)Total	%	35.86 <del>28.49</del>
	b)Rural	"	30.22 <del>24.35</del>
	c)Urban	"	55.48 <del>49.10</del>

9) TRANSPORT & COMMUNICATIONS  
(As on 31st March, 1981).

9.1	Total Railway Length	Km	154
9.2	Total (extra Municipal) Road Length.	"	7455
9.3	Length of Roads per 100 Sq.km area.	"	45.72
9.4	Length of Roads per lakh of population.	"	306.35
9.5	Total Number of Post Offices (1980-81).	No.	443
9.6	Total Number of Telegraph Offices.	"	75

10) OTHERS (1979) :

10.1	Total Number of Banking Offices.	"	186
------	----------------------------------	---	-----

( vii )

=====

1.	2.	3.	4.
----	----	----	----

=====

10.2	Number of Banking Offices per lakh of population (1981).	No.	7
------	---	-----	---

11) MISCELLANEOUS :

11.1	Number of Urban Centres.	"	10
11.2	Number of Municipal Towns.	"	9
11.3	Number of Municipal Towns for which Development Plans prepared/sanctioned.	"	9/9
11.4	Number of Non-Municipal Towns for which Development Plans prepared/sanctioned.	No.	1/1
11.5	Number of Municipal Towns for which Revised Dev.Plans prepared/sanctioned.	"	2/1
11.6	Number of Town Planning Schemes sanctioned.	"	Nil.
11.7	Regional Plans prepared/sanctioned.	"	1/1

=====

---

NOTE : Separate figures for bifurcated Aurangabad District are not available and hence those for old Aurangabad District are given.

---

AURANGABAD

1. Name of Town or City. : Aurangabad

2. Geographical Location and Administrative Functions. : Latitude - 19° 53' North  
Longitude - 75° 20' East.

Aurangabad is the headquarters of Aurangabad District as well as that of Aurangabad Revenue Division. It is situated on the Manmad-Secunderabad metre-gauge line of the South-Central Railway. It is also connected by State Highways with Pune, Ahmednagar, Jalgaon and Hyderabad. Aurangabad City is also connected by air service to Bombay and Delhi. The world famous Ellora and Ajanta Caves have put Aurangabad on the tourist map of the World. It is a municipal town having its Corporation recently established.

3. Geographical & Physical Features. : Aurangabad is situated on the Kham river which originates from Sinhyachal hills passes through the town and flows in south-westerly direction. The city stands in the Dudhana valley between the Lakenvara range on the north and the Sattara hills on the south. The city occupies very uneven ground and the land slopes gradually towards south-west. There is a ridge in north-south direction to the east of the town.

The climate of the town is characterised by a hot summer and general dryness throughout the year except during the south-west monsoon season. The wind direction is from east to west during winter and vice-versa during other seasons.

The physical aspects of the city are as under :-

- i) Altitude - 564.0 above M.S.L.
- ii) Rainfall - 792.1 m.m.
- iii) Temperature.
  - a) Maximum - 42.4<sup>o</sup> c
  - b) Minimum - 8.4<sup>o</sup> c

4. Brief History

Aurangabad is a historic city. It was founded on the site of village Khirki in 1610 A.D. by Malik Ambar, the Prime Minister of Murtaza Nizam Shah of Ahmednagar & soon after it came under the possession of the Moghals. In 1653 Prince Aurangzeb was appointed the Viceroy of the Deccan & he changed the name as Aurangabad and made this city as his capital. He also caused a wall to be built round the city in 1682 in order to protect from the sporadic attacks of the Marathas.

The world famous caves of Ellora & Ajanta are located near this city. The Buddhist temples excavated during the period 368 A.D. to 700 A.D. belong to the latter period of Buddhism. Ghrishneshwar Temple which is one of the twelve Jyotirlingas is situated near Ellora caves. There are three groups of caves in the precipitous scrap of the hills to the north of Aurangabad city, scattered over a distance of about 3 km.

There are a number of Masjids, Tombs and Rozas. Some historical monuments like Bibi-Ka-Makbara; Barra Dari, Jumma Masjid, Kali Masjid, Killa Arak are the places of interest worth visiting.

5. Demography

	1941	1951	1961	1971	1981
a) Population -	41644	57949	87579	150483	284607
b) Decadal Variation(%) -	<u>1941-51</u>	<u>1951-61</u>	<u>1961-71</u>	<u>1971-81</u>	
	39.15	51.13	71.83	94.85	
c) Sex Ratio -	1) 1971 Census	-	830		
(females per 1000 males population)	2) 1981 Census	-	870		

d) Labour Participation Ratio

i) Percentage of Total Workers to total population. i) 1971 Census - 24.74

ii) Percentage of Main Workers to Total Population. ii) 1981 Census - 25.32

e) Occupational Structure

I) As per 1971 Census.

Sr. No.	Category	Workers		Percentage of workers to total workers.
		Males	Females	
1.	2.	3.	4.	5.
1.	Cultivators ..	753	23	
2.	Agricultural Labourers ..	659	180	
3.	Live-stock, Forestry, Fishing, Hunting, Plantations, Orchards etc. ..	930	55	
4.	Mining and Quarrying ...	4		
<u>I. Total Primary Sector</u>		<u>2346</u>	<u>258</u>	<u>6.99</u>
5.	Manufacturing, Processing, Servicing & Repairs. ..			
	a) Household Industries ..	566	104	
	b) Other than Household Industries. ..	4891	272	
6.	Construction ..	3218	466	
<u>II. Total Secondary Sector..</u>		<u>8675</u>	<u>842</u>	<u>25.56</u>
7.	Trade & Commerce ..	7114	214	
8.	Transport, Storage and Communications. ..	3366	61	
9.	Other Services ..	12104	2252	
<u>III. Total Tertiary Sector ..</u>		<u>22584</u>	<u>2527</u>	<u>67.45</u>
Total Workers I+II+III ..		33605	3627	100.00

II) As per 1981 Census

Sr. No.	Category	Workers		Percentage of workers to total workers.
		Males	Females	
1	2	3	4	5
1	Cultivators-I	823	91	1.22
2	Agricultural Labourers II	957	476	1.93
3.	Household Industry, Manufacturing, Processing, Servicing and Repairs.	1702	494	2.95
4.	Other Workers(III, IV, V(b), VI to IX)	59772	7751	90.79
5.	Total Main workers (I to IX)	63254	8812	96.89
6.	Marginal Workers	1543	769	3.11
7.	Total Workers (Sr.No. 5 + 6)	64797	9581	100.00

f) Disabled Population by Type of Disability (1981(2) Census)

Blind	Crippled.	Dumb	Total Physically Handicapped.
1	2	3	4
116	122	39	277

g) Age, Structure (As per 1971 Census)

AGE GROUPS				
0 - 14	15 - 39	40 - 59	60 & above	Age not stated
1	2	3	4	5
59735	65127	18929	6652	40

h) Literacy (%) :

Census Year	Males	Females	Total
1	2	3	4
1) 1971	65.43	41.23	54.22
2) 1981	69.11	48.67	59.58

- i) Town Density : I) 1971 - 28 persons per Hectare  
Census  
II) 1981 - 53 persons per Hectare  
Census

6. AVAILABILITY  
OF PHYSICAL  
INFRASTRUCTURE  
(1981-82)

a) i) Number of Households : 51646  
(As per 1981 Census)

ii) Number of occupied Residential Houses : 50313  
(As per 1981 Census)

b) Water Supply : Purified chlorinated piped water supply is available to the town. The supply of water was once upon a time abundant. The source of water is kham and Harsul Tanks, and Jayakwadi Dam. The per capita water supply is about 26 litres *per day*

*/on Godavari river.*

i) No. of Public Stand Posts - 307

ii) No. of Household connections. - 13615

c) Drainage.

The city is being provided with an underground drainage system by the Environmental Engineering Department of the

Maharashtra State. An elaborate pucca Stone-lined drainage system covers the major part of the city. The length of pucca gutter is 105925 mt. and that of kutchha gutters is 27065 mt.

d) Electricity :

The present electricity supply is made by the Maharashtra State Electricity Board. The power house Harsul is situated at a distance of 4 km away from the town.

e) Transport & Communications.

(I) Transport -

A) Air - Aurangabad is connected by a daily air service to Bombay and Delhi.

b) Rail - The Manmad - Sikandra-bad metre-gauge railway line touches Aurangabad. The most important towns viz. Vaijapur, Jalna, Parbhani, Nanded etc. lie on this line.

C) Roads -

i) External - The following State Highways and Major District roads connect Aurangabad with other towns and cities :-

a) State Highways-

1. Aurangabad-Paithan
2. Jalgaon-Aurangabad-Ahmednagar-Pune
3. Aurangabad-Dhule-Chalisgaon
4. Nashik-Aurangabad-Jalna-Ardhapur-Bhokar-Nirmal Road.



b) Major District Roads

1. Aurangabad caves road.

(ii) Internal-

The major internal roads-

- 1) Railway Station to Delhi-Gate
- 2) Railway Station to Gul-  
mandi
- 3) Mill Corner to Gulmandi
- 4) Delhi Gate to Shahaganj

The typewise length of internal roads is indicated below :-

- |                       |   |           |
|-----------------------|---|-----------|
| 1) Black Topped Roads | - | 90.708 km |
| 2) Cement Concrete    | - | 9.730 km  |
| 3) W.B.M. Roads       | - | 69.492 km |
| 4) Other roads        | - | 25.534 km |

TOTAL : 195.464 km

The average road width is about 18 metres.

iii) Availability of City Buses for Intracity movement.

: The city bus service is provided to the residents of the town. The buses ply on the following routes -

- 1) Railway Station to Shahaganj
- 2) Railway Station to Paithan gate
- 3) Cantonment to Railway station
- 4) Railway station to Chikalhana
- 5) Shahaganj to Harsul
- 6) Shahaganj to Railway station
- 7) Shahaganj to Chikalhana
- 8) Shahaganj to SIDCO

: B) Communications -

- i) No. of Telephone connections - 4800
- ii) No. of Post Offices - 21
- iii) No. of Telegraph Offices - 1
- iv) No. of Post Offices having Telegraph facility - 12

f) Fire Service : Fire service is available to the town with 2 fire fighter engines.

7. AVAILABILITY OF SOCIAL INFRASTRUCTURE  
(1982 - 83)

a) Education (1982-83)

I) Primary - Primary Schools are run by Zilla Parishad and Private Institutions.

- i) No. of Pre-primary schools : 24
- ii) No. of students in pre-primary schools : 1934
- iii) No. of Primary Schools : 107 (Z.P.-10, Municipal Council-47 and Private-50)
- iv) No. of students in Primary Schools : 45771 (Z.P.-5893, M.C.-16580 and Private-23298)
- v) No. of Primary Schools in own premises : 35 (Z.P.-5, M.C.-20, Private-10).
- vi) No. of Primary Schools in hired premises : 72 (Z.P.5, M.C.-27, Private-40)
- vii) No. of Primary Schools having playground facility : 107

II) Secondary -

- i) No. of Secondary Schools. : 39  
(Govt. 1, Z.P.-3 and Private-35)
- ii) No. of Students in Secondary Schools. : 25831  
(Govt.-199, Z.P.-2538, Private-23094)
- iii) No. of Secondary Schools in own premises. : 4 (Govt.-1, Z.P.-3)
- iv) No. of Secondary <sup>schools</sup> / in hired premises. : 35 (Private)
- v) No. of Schools having playground facility. : 39

III) Higher -

- i) No. of Colleges : 18
- ii) No. of Students : 12352

IV) Technical -

- i) No. of Institutes : 4
- ii) No. of Students : 2141

b) Health (1981-82)

- i) No. of Public Dispensaries. : 4
- ii) No. of Public Hospitals. : 2
- iii) No. of Veterinary Dispensaries. : 1
- iv) No. of Public Latrines : Seats - 965

- v) No. of slums/Zopad-patties. : Slums - 70  
Zopadpatties - 27
- vi) Slum Population residing in slum areas or Zopadpatties. : Not available.

c) Recreational Facilities and Amenities.(1981-82)

- i) No. of Parks and Gardens : Parks -10  
Gardens - 1
- ii) No. of clubs : 4
- iii) No. of Public libraries : 4
- iv) No. of Public Playgrounds. : Not available
- v) No. of Public meeting places : 2 (Area- Not available)
- vi) Availability of Open Space (Per 1000 population As per 1981) : Not available.
- vii) No. of Cinema Theatres : 11
- viii) No. of Drama Theatres. : 2. In addition to this there is one Open Air Theatre.
- ix) No. of Swimming Pools. : - Nil -
- x) No. of Gymnasia : 2

8. OTHER FACILITIES IN THE TOWN/CITY(1981-82) :

- a) Agricultural Produce Market Yard. : The Agricultural Produce Market Yard was established in the year 1934. The Municipal limits of Aurangabad have been

made as the market yard for the purpose. However the jurisdiction of the market extends over a radius of 12 miles around the city. The Agricultural Produce Market Committee has brought under its regulation the fifty-four commodities like Jawar, Wheat, rice, Bajra, gur, cotton, moong, Jaggery etc. The market yard is spacious and provides the necessary amenities such as drinking water, weighing shed, storage shed, electric lights and approach roads.

- b) Weekly Bazar : The weekly bazar is held on every Sunday at Jaffar gate and Monday at Usmanpura.
- c) Vegetable Market : There are 5 constructed vegetable Markets at Shahanganj, Aurangapura, Pirezazar, Railway Station and Usmanpura.
- d) Fish & Mutton Market. : There are 4 constructed fish and mutton markets in the town.
- e) No. of organised Shopping Centres. : The facility of organised shopping centres is available to the residents of the town.
- i) Shopping Centres-8  
ii) No. of Shops -298
- f) No. of Banks : 63 (Nationalised 45, Commercial 3, and Co-operative - 15.)
- g) No. of Registered Shops/Establishments. : 6771

h) No. of Police Stations. : 3

i) No. of Police Out Posts or Police Chowkies : 8

9. INDUSTRIES IN THE TOWN (1981-82)

: As per 1971 Census the functional classification of the town is 'Service and Industry'. The industrial estate is developed near the Railway Station. Silk Mill, Jinning and Pressing factories, Oil Mills, Dal and Flour Mills have been located on the south-west of the railway station and near Jaffar Gate. The Aurangabad Cloth Mill is located on the south-west of the fort wall. The factories like engineering, metal works, printing presses have been dispersed in the heart of the city.

10. INCOME AND EXPENDITURE OF AURANGABAD MUNICIPAL COUNCIL (1981 - 82)

I) Income

a) Total Tax Revenue : Rs. 15,172,959/-

b) Per Capita Tax Revenue : Rs. 53.31  
(As per 1981 Census)

c) Total Non-tax Revenue : Rs. 12,16,358/-  
(inclusive of grants and loans and extraordinary debts)

d) Per Capita Non-tax Revenue (inclusive of grants, loans) : Rs. 42.57

e) Total Income : Rs.31640570  
 (inclusive of opening  
 balance & excluding  
 extraordinary debts.)

f) Per capita total income: Rs.111.17  
 (As per 1981 Census)

II) Expenditure

a) Total Expenditure : Rs.27906928  
 (excluding extraordinary  
 debts, deposits &  
 closing balance)

b) Per capita total : Rs.98.05  
 Expenditure (As per  
 1981 Census).

11. BREAK UP OF LAND USE :  
 (As per Development Plan)

Sr. No.	Item	(Area in Hectares)	
		Existing land-use	Proposed land-use
1	2	3	4
	Reference Year	1972	1985
1.	Residential	273.20	1065.20
2.	Commercial	22.00	82.20
3.	Industrial	96.00	192.00
4.	Public and Semi-public	498.00	623.50
5.	Public Utility	8.00	8.00
6.	Garden & Playground	64.00	190.90
7.	Transport & Communication	103.00	406.00
8.	Agricultural lands	2150.00	2740.20
9.	Water bodies	101.00	72.40
10.	Vacant & Barran land	2065.20	-
TOTAL :		5380.40	5380.40

12. DEVELOPMENT PLAN :

- a) Date of sanction of Development Plan. : 1.3.1975
- b) Projected Population for: 2,50,000 souls  
the year 1985 as per  
Development Plan.
- c) Town Planning scheme, : Nil  
if any sanctioned on -

Contd....



d) Financial assistance so far released for the implementation of Development Plan.

Sr. No.	Name of the Site	Year in which the F.A. was granted.	Financial Assistance given		
			Loan	G.I.A.	Total
1	2	3	4	5	6
1.	Construction of road from Gandhi Chowk to Labour colony.	1970-71	-	117133	117133
2.	Acquisition and Development of land for Park and Garden in Site Nos. 75 & 77.	1971-72	333800	-	333800
		1976-77	-	32276	32276
		1978-79	-	3100	3100
		1981-82	118000	31000	149000
TOTAL :			451800	66376	518176
3.	Acquisition and construction of 80' D.P. road from 1) Fruit Research centre to smeshan Hanuman and (2) Telephone Exchange & (3) Development of Site No.48, vegetable Market.	1973-74	541775	-	541775
		1975-76	-	20500	20500
		1976-77	-	71000	71000
		1980-81	190000	-	190000
		1981-82	-	68300	68300
TOTAL :			731775	159800	891575
4.	Acquisition of land for 24 metre wide D.P. road from Law College to Paithan Gate.	1980-81	55000	-	55000

... /-

Contd...

1	2	3	4	5	6
5.	Acquisition of land & construction of 80' D.P.road from Fruit Research Centre to Law College.	1972-73 1975-76 1977-78	233870 - -	- 68542 40000	233870 68542 40000
TOTAL :			233870	108542	342412
6.	Construction of bridge across Khadkeshwar Nala.	1976-77	-	62204	62204
7.	Construction of 100' D.P.Road from Rangeen Gate to City Club.	1976-77 1977-78 1978-79	105776 - -	- 30316 18750	105776 30316 18750
TOTAL :			105776	49066	154842
8.	Acquisition and construction of 60' D. P.Road from Central Building to Padampura.	1976-77 1977-78	90966 -	- 14282	90966 14282
TOTAL :			90966	14282	105248
9.	Construction of Fodder Market Site No.54 and road around it.	1976-77 1979-80	160858 -	- 33590	160858 33590
TOTAL :			160858	33590	194448
10.	Construction of Skew Bridge and Construction of 40' D.P.Road in Site No.54.	1977-78 1978-79	- -	43950 12100	43950 12100
TOTAL :			-	56050	56050

Contd...

1	2	3	4	5	6
11.	Construction of Nehru Bhavan in Site No.276.	1975-76	-	195000	195000.
12.	Construction of bridge across Baroodghar Nala on 12 Metre D.P. road from Aurangapura to Dena Bank.	1977-78	140000	7960	147960
13.	Construction of 12 metre wide road from Baroodghar Nala to Dena Bank.	1977-78	-	7050	7050
14.	Construction of D.P.Road from Kranti Chowk to Prin Travel Hotel.	1977-78	-	33400	33400
15.	Construction of 50' D.P.Road from Hirakhan Factory to Polytechnic.	1977-78	-	16800	16800
16.	Construction of footpath on 100' D.P.Road from Mill Corner to S.T.Stand.	1977-78	-	7000	7000
17.	Construction of 100' D.P.Road from Town Hall to City Club.	1977-78	-	5690	5690
18.	Widening of 100' D.P.Road from Mill Corner to M.S.E.B.Office.	1977-78	-	10150	10150

Contd..

1	2	3	4	5	6
19.	Acquisition of land for widening of Road from Chetana Hotel, to Paithan Gate.	1977-78	-	93460	93460
20.	Development of shopping centre Site No.66.	1977-78	-	105270	105270
21.	Acquisition of land and construction of Primary School Site No.30.	1977-78	200000	-	200000
		1979-80	-	51100	51100
		1980-81	-	37200	37200
TOTAL :				200000	88300
					288300
22.	Construction of compound wall site No.114 reserved for extension of cremation ground.	1977-78	30000	-	30000
23.	Construction and widening of road from Central Bldg. to Aurangpura.	1977-78	107000	-	107000
24.	Acquisition of Site No.23 for Mutton Market and land for 40' D.P. Road and construction of Mutton Market.	1978-79	-	12200	12200
		1979-80	-	21900	21900
TOTAL :				107000	34100
					34100
25.	Acquisition of land for widening of 15 metre D.P. road from Nala to Paithan Gate.	1978-79	-	105000	105000

Contd...

1	2	3	4	5	6
26.	Construction of Primary School Bldg. and construction of wire fencing to Site No.97.	1978-79 1979-80 1980-81	- 280000 -	56960 4400 92500	56960 284400 92500
TOTAL :			280000	153860	433860
27.	Construction of Primary School Site No.248.	1979-80 1980-81	135000 49000	- 25400	135000 74400
TOTAL :			184000	25400	209400
28.	Acquisition of land and structure for 80' D.P. road from Paithan Gate to Mondha.	1979-80	-	161160	161160
29.	Acquisition of land and construction of Primary School Site No.1.	1980-81	253000	31500	284500
30.	Acquisition of land under site No.13 Park comprising C.T.S.No.3398.	1980-81 1981-82	100000 161000	- 133000	100000 294000
TOTAL :			261000	133000	394000
31.	Acquisition of land for 24 metres D.P.Road from Mill Corner to Khadkeshwar.	1981-82	232000	67000	299000

Contd....

1	2	3	4	5	6
32.	Acquisition of land for widening of D.P.Road from Dewan Dev-dee to Aurangapura.	1982-83	56000	-	56000
33.	Acquisition of land for widening of D.P.Road from Mill Corner to Sidharth Road.	1982-83	88000	-	88000

YEARWISE TOTAL FINANCIAL ASSISTANCE GIVEN :

<u>Sr.No.</u>	<u>Year</u>	<u>Financial Assistance given</u>		
		<u>Loan</u>	<u>G.I.A.</u>	<u>Total</u>
1	1970-71	-	117133	117133
2.	1971-72	333800	-	333800
3.	1972-73	233870	-	233870
4.	1973-74	541775	-	541775
5.	1974-75	-	-	-
6.	1975-76	-	284042	284042
7.	1976-77	357600	165480	523080
8.	1977-78	477000	415328	892328
9.	1978-79	-	208110	208110
10.	1979-80	415000	272150	687150
11.	1980-81	647000	180600	833600
12.	1981-82	511000	299300	810300
13.	1982-83	144000	-	144000
<b>TOTAL :</b>		<b>3661045</b>	<b>1948143</b>	<b>5609188</b>

GANGAPUR

1. NAME OF TOWN : Gangapur.

2. GEOGRAPHICAL LOCATION AND ADMINISTRATIVE FUNCTIONS. : Latitude -  $19^{\circ} 42'$  N  
Longitude -  $75^{\circ} 3'$  E

Gangapur is the headquarters of the tahsil of the same name in Aurangabad District. It is a 'C' class Municipal Council. It is situated at a distance of 32 km from Aurangabad the district place. The nearest Railway Station for this town is Lasur at about 26 km. away. Gangapur Municipality was constituted in 1943 and is presently governed under the Maharashtra Municipalities Act, 1965. The Municipal Council has jurisdiction of 1242.10 Hectares.

3. GEOGRAPHICAL AND PHYSICAL FEATURES. : Generally Gangapur town falls in the flat terrain. Godavari river flows at a distance of 6.5 km. from the town towards its south.

i) Altitude - 479.0 Metres  
above M.S.L.

ii) Rainfall - 692.1 m.m.

iii) Temperature

Maximum -  $43.3^{\circ}$  c

Minimum -  ~~$27.0^{\circ}$~~  e  $8.4^{\circ}$  c

The climate of Gangapur is generally dry and healthy. The winds are generally light to moderate with increase in speed during the latter half of the hot season & in the monsoon season. They are mostly from directions between south-west and north-west during the south-west monsoon season while they blow mostly from the directions between north-east and south-east during the rest of the year.

4. BRIEF HISTORY

: The town has no historical importance. The town was formerly known as Gandapur. A legend relates that a Muhammedan saint miraculously supplied a large quantity of 'ganda' or sugarcane juice and helped a ruler, who was passing by to quench his intense thirst. Hence it was called Gandapur.

The agent of Peshwa regime used to reside in this town for collecting the Maratha share of the revenue and the ruins of his Kacheri (office) are still seen on the western side of the town.

5. DEMOGRAPHY

a) Population

1941	1951	1961	1971	1981
-	5323	6463	8871	11468

b) Decadal variation (%)

1941-51	1951-61	1961-71	1971-81
-	21.42	37.26	29.28

c) Sex Ratio  
(Females Per  
1000 Male  
Population)

: i) 1971 - 903  
Census  
ii) 1981 - 901  
Census

d) Labour Participation Rate

: i) Percentage of Total - 1971 -29.44  
Workers to total Census  
population.  
ii) Percentage of Main - 1981 -30.07  
workers to Total Census  
population.

Contd..



e) Occupational Structure  
I) As per 1971 Census.

Sr. No.	Category	Workers		Percentage of workers to total workers.
		Males	Females	
1	2	3	4	5
1.	Cultivators	527	88	
2.	Agricultural Labourers	530	316	
3.	Livestock, Forestry, Fishing, Hunting, Plantation, Orchards etc.	39	-	
4.	Mining & Quarrying.	-	-	
I)	Total Primary Sector	1096	404	57.43
5.	Manufacturing, Processing, Servicing and Repairs.			
	a) Household Industries	71	6	
	b) Other than Household Industries.	150	2	
6.	Construction.	27	-	
II)	Total Secondary Sector	248	8	9.80
7.	Trade & Commerce	289	12	
8.	Transport, Storage and Communications.	57	-	
9.	Other Services.	456	42	
	Total Tertiary Sector	802	54	32.77
	Total Workers I+II+III	2146	466	100.00

II) As per 1981 Census

Sr. No.	Category	Workers		Percentage of workers to total workers.
		Males	Females	
1	2	3	4	5
1.	Cultivators (I)	476	67	15.39
2.	Agricultural Labourers(II)	697	599	36.73
3.	Household Industry, Manufacturing, Processing, Servicing & Repairs(V(a))	42	4	1.31
4.	Other Workers(III, IV, VI to IX)	1496	68	44.33
5.	Total Main Workers (I to IX)	2711	738	97.76
6.	Marginal Workers	46	33	2.24
7.	Total Workers (Sr.No. 5+6)	2757	771	100.00

f) Disabled population by Type of Disability. (1981 Census)

Totally Blind	Totally Crippled.	Totally Dumb	Total No. of physically handicapped persons.
6	8	1	15

g) Age Structure (As per 1971 Census)

Age Groups				
0-14	15-39	40-59	60 & above	Age not stated
3825	3318	1219	509	-

h) Literacy (%)

Census Year	Males	Females	Total
i) 1971 Census	57.81	29.34	44.30
ii) 1981(P) Census	63.08	35.14	49.83

- i) Town Density : i) 1971 - 7 Persons per Hectare  
Census  
ii) 1981 - 9 Persons Per Hectare  
Census

6. AVAILABILITY OF PHYSICAL INFRA-STRUCTURES(1981-82)

- a) i) Number of Households - 1933  
(As per 1981 Census)  
ii) Number of Occupied Residential Houses - 1919  
(As per 1981 Census)
- b) Water Supply : Purified chlorinated piped water supply is provided to the town. Source of water is from Godavari river. The per capita water supply is about 28 litres per day.  
i) No. of Public Stand Posts - 50  
ii) No. of Household connections. - 530
- c) Drainage : Underground drainage system is yet to be introduced in the town. At present there is open drainage system. The drains are stone-lined open gutters. The length of pucca gutters is 2.170 km. and that of kutchha gutters is 1.75 km.

d) Electricity : The present electricity supply is made by the Maharashtra State Electricity Board through its sub-station Gangapur which is 1 km away from the town.

e) Transport and Communications. : I) Transport -

A) Rail - The town is not connected by railway. The nearest railway station is Lasur on the Manmad-Kacheguda metre gauge railway line of the south-central Railway which is 27.5 km. away from Gangapur.

B) Roads - i) External - The town is connected by the following major district roads :-

- 1) Aurangabad-Ahmednagar Road
- 2) Gangapur-Vaijapur-Bhendala
- 3) Deogaon-Gangapur-Kaigaon

ii) Internal - Following are the main internal roads of the town -

- 1) Dak Ghar Road
- 2) Bazar Road (Main Road)
- 3) Pardeshipura Road

The typewise length of the internal roads is as under-

- 1) Asphalted - 2.170 km.
- 2) Cement concrete - Nil
- 3) Other - 1.750 km.

Total - 3.920 km.

The average road width is about 5 metres.

iii) Availability of city/Town Buses for intracity/Town movements - The facility of intracity bus service is not provided to the town.

II) Communications -

- i) No. of Telephone connections. - 80
- ii) No. of Post Offices. - 1
- iii) No. of Telegraph Offices. - Nil
- iv) No. of Post Offices having Telegraph facility. - 1

f) Fire Service : The fire service is not made available to the town by the Municipal Council.

7. AVAILABILITY OF SOCIAL INFRASTRUCTURE (1982-83)

a) Education

The Primary Schools are run by Zilla Parishad and Private Institutions.

i) Primary

- i) No. of Pre-primary Schools. - Nil
- ii) No. of Students in Pre-Primary Schools. - Nil
- iii) No. of Primary Schools - 5 (Z.P.-4 Private-1)
- iv) No. of Students in Primary Schools. - 2170 (Z.P.-2000, Private-170)

- v) No. of Primary Schools in own premises. - 4 (Run by Z.P.)
- vi) No. of Primary Schools in hired Premises. - 1 (Run by Private institute)
- vii) No. of Primary Schools having playground facility. - 5

II) Secondary -

- i) No. of Secondary Schools. - 2 (Z.P.-1, Private-1)
- ii) No. of Students in Secondary Schools. - 1221 (Z.P.-926, Private-295)
- iii) No. of Secondary Schools in own Premises. - 1 (run by Z.P.)
- iv) No. of Secondary Schools in hired premises. - 1 (Run by Private Institute)
- v) No. of Schools having playground facility. - 2

III) Higher -

- i) No. of Colleges - 1 (Arts & Commerce)
- ii) No. of Students - 460
- iii) No. of Colleges having playground facility. - 1

IV) Technical -

- i) No. of Institutes - Nil
- ii) No. of Students - Nil

b) Health (1981-82) -

- i) No. of Public Dispensaries. : 1 (Run by Z.P.) (@)  
@ Leprosy Control Centre. : Nil
- ii) a) No. of Public Hospitals. : Nil  
b) No. of beds in Hospitals. : Nil
- iii) No. of Veterinary Dispensaries. : One (Run by Zilla Parishad)
- iv) No. of Public Latrines : 4 (40 seats)
- v) No. of slum/ Zopadpatties. : Nil
- vi) Slum Population residing in slum areas or zopadpatties. : Nil

c) Recreational Facilities and Amenities (1981-82)

- i) No. of Parks & Gardens. : Parks - 1  
Gardens - Nil
- ii) No. of clubs : 1 (Lions Club)
- iii) No. of Public Libraries. : 2
- iv) No. of Public Playgrounds. : Nil
- v) No. of Public Meeting places. : Nil
- vi) Availability of open spaces (\*) : Nil  
(Per 1000 Population)  
As per 1981 Census.
- vii) No. of Cinema Theatres : Nil
- viii) No. of Drama Theatres : Nil
- ix) No. of Swimming Pools : Nil
- x) No. of Gymnasia : 1

Note (\*) Open space includes the area of public playgrounds and public meeting places.

8. OTHER FACILITIES :  
IN THE TOWN/CITY  
(1981-82)

- a) Agricultural Produce : The Agricultural Produce Market Committee was established in the year 1973. It has brought under its regulation the commodities like Wheat, Jowar, Bajra, Gram, Tur, Mug, Kulthi, Math, Safflower and Linseed. The total area covered by the Agricultural Produce Market Yard is 6 Hectares. The Agricultural Produce Market Committee has a jurisdiction over 200 villages.
- b) Weekly Market : The weekly bazar is held on every Saturday in front of the Bus stand.
- c) Vegetable Market : One. The Municipal Council has constructed some Ottas and shops which serve the purpose of a Vegetable Market. It admeasures an area of about 625 sq.mtrs.
- d) Fish & Mutton Market : There is no built up Fish and Mutton Market provided by the Municipal Council. The fish and mutton are sold in Private shops.
- e) No.of organised shopping centres. : Nil.
- f) No. of Banks : 5 (Out of 5 banks 2 are Nationalised, 2 are co-operatives and one is a commercial one).
- g) No.of Registered Shops/Establishments. : Nil.
- h) No.of Police Stations: 1
- i) No.of Police Outposts: Nil.



9. INDUSTRIES  
IN THE TOWN  
(1981-82) : As per 1971 Census the functional classification of the town is 'Primary'. There are no industries worth mentioning in the town.

10. INCOME AND EXPENDITURE  
OF GANGAPUR MUNICIPAL  
COUNCIL (1981-82)

I) Income -

- |  |   |             |
|--|---|-------------|
| a) Total Tax Revenue                                       | : | Rs.3,22,722 |
| b) Per Capita Tax Revenue (As per 1981 Census)             | : | Rs.28.14    |
| c) Total Non-Tax Revenue (inclusive of grants and loans)   | : | Rs.4,57,066 |
| d) Per Capita Non-Tax Revenue (inclusive of grants, loans) | : | Rs.39.86    |
| e) Total Income (inclusive of opening balance)             | : | Rs.9,70,404 |
| f) Per Capita Total Income. (As per 1981 Census)           | : | Rs.84.62    |

II) Expenditure -

- |  |   |             |
|--|---|-------------|
| a) Total Expenditure                                 | : | Rs.8,43,281 |
| b) Per Capita Total Expenditure (As per 1981 Census) | : | Rs.73.53    |

11. BREAK UP  
OF LAND USE  
(As per Dev.Plan)

Sr. No.	Item	(Area in Hectares)	
		Existing: land-use 3	proposed land-use 4
1	2		
	Reference Year	1971	1991
1.	Residential	20.38	60.75
2.	Commercial	2.52	6.64
3.	Industrial	0.66	8.67
4.	Public & Semi Public	10.59	17.43
5.	Public Utilities	0.29	0.29
6.	Garden and Playgrounds	0.58	7.07
7.	Transport and Communication	36.71	48.51
8.	Agriculture	1107.81	1072.49
9.	Water Bodies	11.16	11.16
10.	Vacant and Barren Land	43.20	-
11.	Cremation Ground	8.20	9.09
TOTAL :		1242.10	1242.10

12. DEVELOPMENT PLAN :

- a) Date of sanction of Development Plan. - 1.6.1972
- b) Projected Population for the year 1991 as per Development Plan - 10,000
- c) Town Planning Scheme, if any, sanctioned on - Nil

d) Financial assistance so far released  
for the implementation of Development Plan.

Sr. No.	Name of the Site	1971-72	1972-73	1977-78	1978-79	1979-80					
		Loan	G.I.A.	Loan	G.I.A.	Lo-	G.I.A.	Lo-	G.I.A.	Lo-	G.I.A.
1	2	3	4	5	6	7	8	9	10	11	12
1.	a) Construction of three roads	48972	48972	-	-	-	-	-	-	-	-
	b) Acquisition of sites for										
	1) Open Space (Sr.No.1)										
	2) Pry. School (S.No.7)										
	3) Weekly Market (S.No.10)										
	4) Cremation Ground (S.No.13)										
2.	a) Acquisition of Site 12(a)	-	-	61300	12260						
	b) Construction of Masonry Surface drains on both sides of 3 roads.										
3.	Construction of Primary School Site No.7.	-	-	-	-	98900	-	37160	-	50000	

Contd....

Contd....

Sr. No.	Name of the Site	1980-81		1981-82		1982-83		Total	
		Loan	G.I.A.	Loan	G.I.A.	Loan	G.I.A.	Loan	G.I.A.
1	2	13	14	15	16	17	18	19	20
1.	a) Construction of three roads	-	-	-	-	-	-	48972	48972
	b) Acquisition of sites for								
	1) Open Space (Sr.No.1)								
	2) Pry. School (S.No.7)								
	3) Weekly Market (S.No.10)								
	4) Cremation Ground (S.No.13)								
2.	a) Acquisition of Site 12(a)	-	-	-	-	-	-	61300	12260
	b) Construction of Masonry Surface drains on both sides of 3 roads.								
3.	Construction of Primary School Site No.7	-	85000	-	10000	-	-	-	280160

Contd....

1	2	3	4	5	6	7	8	9	10	11	12
4. Acquisition of land under site No.10 reserved for weekly Market.	-	-	-	-	-	-	-	-	19000	-	13600
5. Construction of weekly market including vegetable stalls in Site No.10.	-	-	-	-	-	-	-	-	-	-	223350
6. Construction of Public Latrine in S.No.1.	-	-	-	-	-	-	-	-	-	-	19400
7. Acquisition of Land for Rehabilitation of L.I.G. Persons S. No.12-A.	-	-	-	-	-	-	-	-	-	-	35300
8. Development of Garden in S.No.1.	-	-	-	-	-	-	-	-	-	-	-
9. Construction of Public Latrines near Old Weekly Market.	-	-	-	-	-	-	-	-	-	-	-
TOTAL :		48972	48972	61300	12260	-	98000	-	56160	-	341650

1	2	13	14	15	16	17	18	19	20
4. Acquisition of land under site No.10 reserved for weekly Market..	-	-	-	-	-	-	-	-	32600
5. Construction of weekly market including vegetable stalls in Site No.10.	98000	130000	-	50000	-	-	98000	403350	
6. Construction of Public Latrine in S.No.1.	-	23700	-	-	-	-	-	-	43100
7. Acquisition of Land for Rehabilitation of L.I.G.Persons S. No.12-A.	-	-	-	-	-	48900	-	-	84200
8. Development of Garden in S.No.1.	-	75000	-	-	-	51900	-	-	126900
9. Construction of Public Latrines near Old Weekly Market.	-	-	-	-	-	23700	-	-	23700
<b>TOTAL :</b>	98000	313700	-	60000	-	124500	208272	1055242	

KANNAD

1. NAME OF THE TOWN : Kannad
2. GEOGRAPHICAL LOCATION AND ADMINISTRATIVE FUNCTIONS. : Latitude - 20° 16' N  
Longitude - 75° 11' E

Kannad is the headquarters of Kannad Tahsil in Aurangabad District. It is situated on Aurangabad-Chalisgaon State Highway. The District headquarters Aurangabad is 63 kilometres away and the nearest railway station on Bombay-Calcutta main line is Chalisgaon which is about 32 km. away from Kannad. It is a 'C' class Municipal Town and its Municipal Council was established in 1945. The total Urban Area under the council is 104.80 ha.

3. GEOGRAPHICAL AND PHYSICAL FEATURES. :

Kannad is bounded on west, south and east by the rivers Bamni and Shivna. The confluence of these two rivers <sup>is</sup> ~~is~~ south of old <sup>gacthan</sup> ~~the~~ three sides. One big nala flows almost north-south through the Municipal limits. The wind direction is from west to east for most of the days in the year.

i) Altitude - 627.6 m. above M.S.L.

ii) Rainfall - 870.0 mm.

iii) Temperature

a) Maximum - 42.2°c

b) Minimum - 7.0°c

4. BRIEF HISTORY :

In olden times Kannad used to be a place of much importance. It is said that the original name of the town was

Kanakawati. Kanak means gold and the name Kanakawati indicated it as a place abundant in wealth. The world famous Ellora Caves and temple of Ghrishneshwar which is one of the twelve Jyotirlingas are on its south. It is said that the observatory of the well-known Astronomer Pandit Bhaskaracharya was located here. Kannad suffered much from the great famine that occurred about the beginning of the 19th Century and from the ravages of the Bhills. Though the Marathas destroyed a number of Bhills they continued to be troublesome which necessitated stationing a portion of Nizam's contingent at Kannad.

5. DEMOGRAPHY

a) Population :

1941	1951	1961	1971	1981
5490	5767	7027	10398	16351

b) Decadal variation(%)

1941	1951	1961	1971
- 51	- 61	-71	-1981
5.05	21.85	47.97	57.65

c) Sex Ratio :  
(Females per  
1000 Males  
population.)

i) 1971 - 924

ii) 1981 - 912

d) Labour :  
Participation  
Ratio.

i) Percentage of - 1971 - 17.92  
total workers Census  
to total  
population.

ii) Percentage of - 1981 - 30.53  
Main workers Census  
to total  
population.



e) Occupational Structure

I) As per 1971 Census.

Sr. No.	Category	Workers		% of workers to total workers.
		Males	Females	
1	2	3	4	5
1.	Cultivators	453	53	
2.	Agricultural Labourers	267	150	
3.	Live Stock, Forestry, Fishing, Hunting Plantation, Orchards etc.	62	1	
4.	Mining & Quarrying	-	-	
I)	TOTAL-Primary Sector	782	204	33.55
5.	Manufacturing, Processing, Servicing and repairs.			
	a) Household Industries	95	6	
	b) Other than Household Industries.	219	19	
6.	Construction	68	5	
II)	TOTAL-Secondary sector	382	30	14.02
7.	Trade and Commerce	573	25	
8.	Transport, Storage & Communications.	137	2	
9.	Other Service	686	118	
III)	TOTAL-Tertiary Sector	1396	145	52.43
	Total Workers I + II + III	2560	379	100.00

II) As per 1981 Census

Sr. No.	Category	Workers		% of workers to total workers
		Males	Females	
1	2	3	4	5
1.	Cultivators(I)	479	108	11.48
2.	Agricultural Labourers (II)	382	334	14.00
3.	Household Industry, Manufacturing Processing, Servicing and Repairs(V(a))	66	22	1.72
4.	Other Workers (III, IV, V(b), VI to IX)	3108	493	70.40
5.	Total Main Workers ( I to IX)	4035	957	97.60
6.	Marginal Workers	53	70	2.40
7.	Total workers (Sr. No. 5 + 6)	4088	1027	100.00

f) Disabled Population by type of Disability (1981 Census)	Totally Blind	Totally Crippled	Totally Dumb	Total No. of Physically handicapped
	1	2	3	4
	7	17	6	30

g) Age Structure  
(As per 1971  
Census)

AGE GROUPS				
0 -14	15-39	40-59	60 & above	Age not stated.
1	2	3	4	5
4622	3839	1364	573	-

h) Literacy (%)

Census Year	Males	Females	Total
1	2	3	4
1) 1971	58.16	27.39	43.38
2) 1981	62.35	34.15	49.02

i) Town Density

i) 1971 - 99 persons per Hectare  
Census

ii) 1981 - 156 persons per Hectare.  
Census.

6. AVAILABILITY  
OF PHYSICAL  
INFRASTRUCTURE  
(1981-82)

a) i) Number of House- : 2791  
holds (As per  
1981 Census)

ii) Number of Occupied : 2758  
Residential Houses  
(As per 1981 Census)

b) Water Supply

: Chlorinated piped water supply is made to the town from Banni. river water works. The daily per capita water supply is about 18 litres.

i) No. of Public Stand posts - 936.

ii) No. of Household connections-990.

- c) Drainage : Underground drainage system is not provided to the town. But the preliminary work of the underground drainage scheme has been completed. At present surface drainage system by open gutters is in operation. The length of Pucca gutter is 14000 Mtrs. and that of kutcha gutters is 25000 mtrs.
- d) Electricity - : The electricity is supplied to the town by the Maharashtra State Electricity Board. The sub station is situated 2 kms. away from the town.
- e) Transport and Communication. : I) Transport -

A) Rail - The town is not connected by Railway. The nearest railway station is Chalisgaon.

B.) Roads - i) External - Kannad town is connected by the following roads -

- 1) Aurangabad-Chalisgaon State Highway and
- 2) Kannad-Pishore road, a major district road.

ii) Internal - Following are the main internal roads.

- 1) Shivaji Road
- 2) Tilak Road
- 3) Gandhi road

The typewise road length is as under -

- |                    |   |           |
|--------------------|---|-----------|
| 1) Asphalted       | - | 4.00 km.  |
| 2) Cement concrete | - | 1.00 km.  |
| 3) W.B.M.          | - | 8.00 km.  |
| 4) Others          | - | 20.00 km. |

TOTAL : 33.00 km.

The average road width is about 12 Mtrs.

iii) Availability of City/Town Buses for Intra-city/Town movement. - The facility of intracity bus service is not provided to the town.

II) Communications-

- i) No. of Telephone - 88 connections
- ii) No. of Post Offices - 1
- iii) No. of Telegraph Offices. - Nil
- iv) No. of Post offices- 1 having Telegraph facility.

f) Fire Service : The facility of fire service is not made available to the town by the Municipal Council.

7. AVAILABILITY OF SOCIAL INFRASTRUCTURE

a) Education - (1982-83)

I) Primary - Primary schools are run by Zilla Parishad and Private Institutions.

- i) No. of Pre-primary Schools. - Nil
- ii) No. of Students in Pre-Primary Schools. - Nil
- iii) No. of Primary Schools. - 5 (Z.P.-3, Pvt.-2)
- iv) No. of students in Primary Schools. - 2721
- v) No. of Primary Schools in own premises. - 1

- vi) No. of Primary Schools in hired premises. - 4
- vii) No. of Primary Schools having playground facility. - 3 (Private-2, Z.P.-1)

II) Secondary -

- i) No. of Secondary Schools - 3 (Z.P.-1, Private-2)
- ii) No. of students in Secondary Schools. - 1642
- iii) No. of Secondary Schools in own premises. - 2 (Z.P.-1, Private-1)
- iv) No. of Secondary Schools in hired premises. - 1 (Private)
- v) No. of Schools having Playground Facility. - 3

III) Higher -

- i) No. of Colleges - 2 (One Arts and Commerce and 1 Basic Training college.)
- ii) No. of Students - 795 (Arts & Commerce)
- iii) No. of Colleges having playground facility - 1 (Arts and Commerce college has a facility of playground)

IV) Technical -

- 1) No. of Institutes - Nil
- 2) No. of Students - Nil

b) Health (1981-82)

i) No. of Public Dispensaries	- Nil
ii) a) No. of Public Hospitals	- 1 (Run by Z.P.)
b) No. of beds in Hospitals.	- 25
iii) a) No. of Maternity Homes	- Nil
b) No. of beds in Maternity Homes.	- Nil
iv) No. of Veterinary Dispensaries.	- 1 (Run by Z.P.)
v) No. of Public Latrines.	- 10 (Seats -60)
vi) No. of Slums/Zopadpatties	- 2
vii) Slum Population residing in slum areas or zopad-patties.	- 2000

c) Recreational facilities and amenities (1981-82)

i) No. of Parks & Gardens	- Gardens - 5 Parks - Nil
ii) No. of Clubs	- 1
iii) No. of Public Libraries	- 2
iv) No. of Public Playgrounds	- 1 (Area-370 sq. mts.)
v) No. of Public Meeting places	- Nil
vi) Availability of Open Space* (Per 1000 Population) As per 1981(P) Census.	- 22.57 sq.mts.
vii) No. of Cinema Theatres	- 1
viii) No. of Drama Theatres	- Nil
ix) No. of Swimming Pools	- Nil
x) No. of Gymnasias	- Nil

\*NOTE : Open space includes the area of Public playgrounds and public meeting places.

8. OTHER FACILITIES :  
IN THE TOWN/CITY  
(1981-82).

a) Agricultural Produce: Kannad is a fast developing regulated market in the Market Yard. district. It is established on 3rd January, 1964. Kannad Agricultural Produce Market/ is regulated since 1967 under the Act. The Market is located on the Aurangabad-Chalisgaon State Highway. The area of operation of the market committee extends over a radius of 3 Hectares from Kannad, the tahsil place and the entire Kannad Municipal area is declared as market yard. It has brought under its regulation the commodities like Jowar, Wheat, Bajra, Moong, Udid, Cotton, Tobacco, Garlic, Chilis, Onions, Maize, Gram, Gur, Mangoes, Sesamum, Herrip, Math and Vatana. It is an important Sub-Regional Market place for commodities like Jawar, Bajra, Gur, Cotton and Wheat. The market yard is spacious with an office building constructed therein. The Market Yard provides drinking water, cattle sheds, water pipe, electricity, drainage and approach road etc.

/Committee

- b) Weekly Market : The weekly Bazar is held on Monday at which cattle are also bought and sold.
- c) Vegetable Market : There is only one vegetable market.  
(Area. 0.3 Hectares)



- d) Fish & Mutton Market. : At present there are two fish and mutton markets. (Area - 2450 sq.mtrs.)
- e) No.of organised Shopping Centres. : 2 (Shops - 20)
- f) No.of Banks. : 5 (Nationalised -2, Commercial-1 & Co-operative-2)
- g) No.of Registered Shops/Establishments(1981-82) : Nil
- h) No.of Police Stations. : 1
- i) No. of Police Out Posts. : Nil

9. INDUSTRIES IN THE TOWN (1981-82) : As per 1971 Census the functional classification of the town is 'Primary and Service'. The only industry worth name is khandsari sugar Mill. The total number of employees working in it is 250.

10. INCOME AND EXPENDITURE OF KANNAD MUNICIPAL COUNCIL (1981-82)

I) Income

- a) Total Tax Revenue : Rs.745720
- b) Per Capita Tax Revenue (As per 1981 Census) : Rs.45.61
- c) Total Non-Tax Revenue (inclusive of grants and loans) ; Rs.733562

d) Per Capita Non-Tax Revenue. (Inclusive of grants and loans)	:	Rs.44.86
e) Total Income (Inclusive of opening balance)	:	Rs.1609735
f) Per Capita Total Income (As per 1981 Census)	:	Rs.98.45

II) Expenditure

a) Total Expenditure (Excluding Extraordinary debts & closing balance)	:	Rs.962238
b) Per Capita Total Expenditure (As per 1981 Census)	:	Rs.58.85

Contd.....

11. BREAK UP OF  
LANLUSE  
(As per Dev. Plan)

(Area in Hectares)

Sr. No.	Type	Area as per existing land-use	Area as per proposed land-use
1	2	3	4
<u>Reference Year</u>		1972	1991
1.	Residential	12.00	33.20
2.	Industrial	7.60	16.10
3.	Commercial	7.20	8.58
4.	Public & Semi-Public	8.40	10.80
5.	Open Spaces, Parks, Play-ground etc.	3.20	12.00
6.	Transport & Communication	8.80	18.40
7.	Public Utilities	0.80	1.40
8.	Agriculture & Green Belt.	34.40	3.86
9.	Vacant Land	21.60	-
10.	Water bodies.	0.80	0.46
<b>TOTAL :</b>		<b>104.80</b>	<b>104.80</b>

12. DEVELOPMENT PLAN :

- a) Date of sanction of Development Plan. - 1.3.1975
- b) Projected Population for the year 1991 as per Development Plan. - 17000 souls
- c) Town Planning Scheme, if any, sanctioned on - Nil

d) Financial assistance so far released for the implementation of Development Plan.

Sr. No.	Name of the Site	1970-71 :Loan	1977-78 :G.I.A.:Lo- an.	1978-79 :G.I.A.:Lo- an.	1979-80 :G.I.A.:Lo- an.	1980-81 :G.I.A.:Lo- an.					
1	2	3	4	5	6	7	8	9	10	11	12
1.	Construction of Samaj Mandir	75000	75000	-	-	-	-	-	-	-	-
2.	Construction of 40' wide East-West D.P.road from Samaj Mandir to the proposed S.T.Depot.	-	-	-	29250	-	77980	-	-	-	91800
3.	Development of Garden in Site No.31.	-	-	-	78000	-	78640	-	-	-	-
4.	Construction of Slaughter House & Beef Market in Site No.47.	-	-	-	-	-	48000	-	154980	-	23500
5.	Construction of Public Latrines Near Vijay Talkies.	-	-	-	-	-	16000	-	12000	-	21200
6.	Acquisition of land for construction of Primary School in Site No.49.	-	-	-	-	-	-	-	76000	-	-

- 50 -

Contd...

.. 2 ..

Sr.:Name of the Site		1981-82	1982-83	Total			
No.		an.	an.	Loan	G.I.A.		
1	2	13	14	15	16	17	18
1.	Construction of Samaj Mandir	-	-	-	-	75000	75000
2.	Construction of 40' wide East-West L.P.Road from Samaj Mandir to the proposed S.T.Depot.	-	-	-	-	-	199030
3.	Development of Garden in Site No.31.	-	-	-	-	-	156640
4.	Construction of Slaughter House & Beef Market in Site No.47.	-	-	-	7200	-	233680
5.	Construction of Public Latrines Near Vijay Talkies.	-	-	-	-	-	49200
6.	Acquisition of land for construction of Primary School in Site No.49.	-	100000	-	298400	-	474400

d) Financial assistance so far released for the implementation of Development Plan.

Next Sr. Nos. continued.....

Sr. No.	Name of the Site	1970-71		1977-78		1978-79		1979-80		1980-81	
		:Loan	:G.I.A.	:Lo-	:G.I.A.	:Lo-	:G.I.A.	:Lo-	:G.I.A.	:Lo-	:G.I.A.
		an.	an.	an.	an.	an.	an.	an.	an.	an.	an.
1	2	3	4	5	6	7	8	9	10	11	12
7.	Construction of C.D. Work on Road from Sidiqui Chowk to Resthouse.	-	-	-	-	-	-	-	37800	-	21000
8.	Vegetable Market in Site No.29.	-	-	-	-	-	-	-	-	-	61800
9.	Slaughter House in Site No.41.	-	-	-	-	-	-	-	-	-	30500
10.	Construction of Public Latrine 1) In Rajwada 2) In Wadarwada 3) Near Weekly Market.	-	-	-	-	-	-	-	42400	-	-
TOTAL :		75000	75000	-	107250	-	220620	-	323180	-	249800

Contd...

..2..

Sr. No.	Name of the Site	1981-82		1982-83		Total	
		Loan	G.I.A.	Loan	G.I.A.	Loan	G.I.A.
1	2	13	14	15	16	17	18
7.	Construction of C.D.work on Road from sidiqui Chowk to Rest House.	-	-	-	-	-	58800
8.	Vegetable Market in Site No.29.	-	-	-	-	-	61800
9.	Slaughter House in Site No.41.	-	-	-	-	-	30500
10.	Construction of Public Latrine 1)In Rajwada 2)In Wadarwada 3)Near Weekly Market.	-	21200	-	42700	-	106300
TOTAL:		-	121200	-	348300	75000	1445350

KHULDABAD

1. NAME OF TOWN : Khuldabad
2. GEOGRAPHICAL LOCATION AND ADMINISTRATIVE FUNCTIONS. : Latitude - 20° 1' N  
Longitude - 75° 14' S

Khuldabad is a 'C' Class Municipal town and is the headquarters of tahsil of the same name. This town is situated at a distance of 30 kms. from Aurangabad, the district headquarters. It is connected by Aurangabad-Dhule State Highway. The famous Daulatabad fort is about 10 kms and the world famous Ellora Caves are only about 3 kms away from this town.

Khuladabad Municipality was established in 1946 and has an area of 512 hectares under its jurisdiction. A Hill Station Municipal Council has been governed under the Maharashtra Municipalities Act, 1965.

3. GEOGRAPHY AND PHYSICAL FEATURES : Khuladabad lies on a plateau in the Daulatabad hill ranges of Sahyadri mountain. It is an excellent health resort and has therefore become a major tourist centre in this region. There is a nice Government Rest house situated on the hill top. There is also a Zilla Parishad Rest House. There are 3 natural tanks in the vicinity.

i) Altitude - 722.4 Mtrs.

ii) Annual Rainfall - 960.0 mm.

iii) Temperature -

a) Maximum - 39.5°C

b) Minimum - 16.0°C

The Town has a pleasant and temperate climate throughout the year.



4. BRIEF HISTORY : Khuldabad is a famous Muslim religious place. History tells that it was once an important and prosperous town.

there  
In this town/are the tombs of Moghal Emperor Aurangzeb, his son Azam Shah, Nizam-ul-Mulk Asaf Jah, the founder of the Hyderabad dynasty, his second son Nasir Jang, Nizam Shah, King of Ahmednagar and Tana Shah, last of the Golkonda kings.

The table-land between Daulatabad and Khuldabad contained the ruins of an ancient town locally known as Budra-vanti or Budda-Vanti. The material for building Khuldabad was probably taken from these ruins.

The town is surrounded by a high fortified wall constructed by Aurangzeb. It has seven gates.

5. DEMOGRAPHY :

a) Population	:	1941	:	1951	:	1961	:	1971	:	1981
		-		3247		3974		6149		8315

b) Decadal variation. (%)	:	1941-1951	:	1951-1961	:	1961-1971	:	1971-81
		-		22.39		54.73		35.23

c) Sex ratio (Females Per 1000 Males Population)	:	i) 1971 Census	-	1017
		ii) 1981 Census	-	946

- d) Labour Participation Ratio. : i) Percentage of total workers to total population as per 1971 Census. - 26.95
- ii) Percentage of main workers to total population as per 1981 Census. - 26.96

e) Occupational Structure.

I) As per 1971 Census

Sr. No.	Category	Workers		% of workers to total workers.
		Males	Females	
1	2	3	4	5
1.	Cultivators	315	9	
2.	Agricultural Labourers	159	117	
3.	Livestock, Forestry, Fishing, Hunting, Plantation, Orchards etc.	56	9	
4.	Mining & Quarrying.	-	-	
I) Total-Primary Sector		530	135	40.13
5.	Manufacturing, Processing, Servicing and Repairs -			
a)	Household Industries	40	20	
b)	Other than Household Industries	170	1	
6.	Construction	85	6	
II) Total-Secondary Sector		295	27	19.43

Sr. No.	Category	Workers		% of workers to total workers.
		Males	Females	
1	2	3	4	5
Contd.....				
7.	Trade & Commerce	255	11	
8.	Transport, Storage and Communications.	51	-	
9.	Other Services	317	36	
III) Total Tertiary Sector		623	47	40.44
Total Workers I+II+III		1448	209	100.00
II) As per 1981 Census				
1	2	3	4	5
1.	Cultivators (I)	360	82	17.25
2.	Agricultural Labourers(II)	266	297	21.98
3.	Household Industry.Manu- facturing Processing, Servicing & Repairs(V(a)	62	9	2.77
4.	Other Workers(III,IV, v(b), VI to IX)	1130	50	46.06
5.	Total Main Workers (I to IX)	1818	438	88.06
6.	Marginal Workers	77	229	11.94
7.	Total Workers (Sr.No 5 + 6)	1895	667	100.00

f) Disabled Population:

by Type of Disability (1981 (17) Census)	Totally Blind	Totally Crippled	Totally Dumb	Total No. of Physically Handicapped
	8	1	6	15

g) Age Structure  
(As per 1971 Census)

AGE GROUPS				
0-14	15-39	40-59	60 & above	Age not stated.
2900	2086	809	350	4

h) Literacy(%)

Census Year	Males	Females	Total
1) 1971	48.74	22.81	35.66
2) 1981	59.48	34.08	47.13

i) Town Density

- i) 1971 - 12 Persons Per ha. Census
- ii) 1981 - 16 Persons Per ha. Census

6. AVAILABILITY OF PHYSICAL INFRASTRUCTURE  
(1981-82)

- a) i) Number of Households : 1346  
(As per 1981 Census)
- ii) Number of Occupied Residential Houses : 1319  
(As per 1981 Census)

b) Water Supply

: Chlorinated piped water supply is made to the town through the Khaksar reservoir. The daily per capita water supply is about 10 litres which is quite inadequate.

i) No. of Public Stand Posts - 26

ii) No. of Household connections. - 560

c) Drainage

: There is no special drainage system. The drains are masonry like open gutters. The length of gutters is 1524 Mtrs.

d) Electricity

: The town is supplied with electricity by the Maharashtra State Electricity Board. The Sub-Station is situated 3 km away from the town.

e) Transport & Communications

: I) Transport -

A) Rail - Nil.

B) Roads - i) External - Khuldabad is connected by Aurangabad - Dhule State Highway.

ii) Internal - Most of the roads in the town are quite narrow and are not properly constructed so far. Total Internal Road lengths according to surface classification are as follows -

i) Asphalted - 1.00 km.

ii) W.B.M. - 7.05 km.

Total: 8.05 km.

The average road width is about 5 metres.

iii) Availability of City/  
Town Buses for Intra-  
City/Town movement-

The facility of city bus service is not provided to the town.

II ) Communications -

- i) No.of Telephone connections - 35
- ii) No.of Post Offices - 1
- iii) No.of Telegraph Offices. - Nil
- iv) No.of Post Offices having telegraph facility. - 1

f) Fire Service : Fire service is not provided to the town by the Municipal Council.

7. AVAILABILITY OF  
SOCIAL INFRA-  
STRUCTURE

a) Education (1982-83)

I) Primary - Primary Schools are run by the Zilla Parishad and Private Institutions.

- i) No.of Pre-primary Schools : 1 (Private)
- ii) No.of Students in Pre-primary Schools : 30
- iii) No.of Primary Schools : 2 (Run by Z.P.)
- iv) No.of Students in Primary Schools. : 1011
- v) No.of Primary Schools in own premises. : Nil
- vi) No.of Primary Schools in hired premises. : 2
- vii) No.of Primary Schools having playground facility. : 2

II) Secondary -

- i) No.of Secondary Schools - 2 (Run by Private Institute)
- ii) No.of Students in Secondary Schools. - 1011
- iii) No.of Secondary Schools in own Premises. - Nil
- iv) No.of Secondary Schools in hired premises. - 2
- v) No.of Schools having Playground Facility. - 2

III) Higher - There is no facility of Higher Education available in the town.

- iv) Technical - 1) No.of Institutes - 1
- b) Health (1981-82)<sup>2</sup>) No.of Students - 20

- i) No.of Public Dispensaries. - Nil
- ii) (a) No.of Public Hospitals. - 1
- (b) No.of Beds in Hospitals. - 10
- iii) (a) No.of Maternity Homes. - Nil
- (b) No.of beds in Maternity Homes. - Nil
- iv) No.of Veterinary Dispensaries. - 1 (Run by Zilla Parishad)
- v) No.of Public Latrines - 16 (Seats - 26)
- vi) No.of Slums/ Zopadpatties. - Slums - 2  
Zopadpatties-2
- vii) Slum Population residing in slum areas or Zopadpatties. - Slum Population - 500  
Zopadpatty Population-450

c) Recreational  
Facilities and  
Amenities.  
(1981-82)

- i) No. of Parks : Parks - Nil and  
Gardens - 1
- ii) No. of Clubs : Nil
- iii) No. of Public  
Libraries. : 1
- iv) No. of Public  
Playgrounds. : 1 (Area 37161.2 Sq.mts.)
- v) No. of Public  
Meeting Places. : 1 (Area 375 Sq.Mtrs.)
- vi) Availability of  
Open Spaces. (\*) : 4514 Sq.Mtrs.  
(Per 1000 Popula-  
tion) As per  
1981(P) Census.
- vii) No. of Cinema  
Theatres. : Nil
- viii) No. of Drama  
Theatres. : Nil
- ix) No. of Swimming  
Pools. : Nil
- x) No. of Gymnasia : Nil

\*NOTE : Open Space includes the area of public  
playgrounds and public meeting places.

8. OTHER FACILITIES :  
IN THE TOWN(1981-82)

- a) Agricultural Produce : There is no agricultural  
Market Yard. produce market committee  
established as yet in the  
town.
- b) Weekly Market : The Weekly Bazar is held  
on every Wednesday in Site  
No.15.



- c) Vegetable Market : Vegetable Market is not Constructed in the town but the vegetables are sold only in Weekly Market.
- d) Fish & Mutton Market. : At present there is one built up Fish and Mutton Market (Area - 124.41 Sqmtrs.)
- e) No.of Organised Shopping Centres. : Nil
- f) No.of Banks. : 4  
(Out of 4 Banks, 2 are Co-operative, One is Nationalised and one is Commercial Bank.)
- g) No.of Registered Shops/Establishments. : Nil
- h) No.of Police Stations. : 1
- i) No.of Police Out Posts. : Nil
9. INDUSTRIES  
IN THE TOWN  
(1981-82) : As per 1971 Census the functional classification of the town is 'Primary'. There is no industrial development in the town. There is only one spare-part manufacturing industry functioning in the town. The total number of employees working in it is 35.

10. INCOME AND :  
EXPENDITURE OF  
KHULDABAD MUNICIPAL  
COUNCIL (1981-82)

I) Income

a) Total Tax Revenue	: Rs.181518
b) Per Capita Tax Revenue (As per 1981 Census)	: Rs.21.83
c) Total Non-Tax Revenue (inclusive of grants and loans)	: Rs.267242
d) Per Capita Non-Tax Revenue (inclusive of grants and loans)	: Rs.32.14
e) Total Income (inclusive of Opening Balance)	: Rs.719355
f) Per Capita Total Income (As per 1981 Census)	: Rs.86.51

II) Expenditure

a) Total Expenditure	: Rs.546923
b) Per Capita Total Expenditure (As per 1981 Census)	: Rs.65.78

11. BREAK UP OF  
LANDUSE  
(As per Dev.Plan.)

(Area in Hectares)

Sr. No.	Item	Area as per	
		Existing land use	Proposed land-use
1	2	3	4
	Reference Year	1971	1991
1.	Residential	25.51	54.18
2.	Commercial	1.89	8.75
3.	Industrial	4.00	9.20
4.	Transport and Communication.	8.90	18.93
5.	Public and Semi-Public	6.88	22.85
6.	Open Spaces and Garden	2.50	9.56
7.	Water bodies.	10.95	10.22
8.	Guest House and Hills	15.00	12.40
9.	Agricultural and Vacant land.	436.37	365.91
	TOTAL :	512.00	512.00

(\* Area is adjusted for tallying the total)

12. DEVELOPMENT PLAN

- a) Date of sanction of Development Plan. : 2.5.1973
- b) Projected Population for the year 1991 as per Development Plan. : 9,000
- c) Town Planning Scheme, if any, sanctioned : Nil

d) Financial assistance so far released  
for the implementation of Development Plan.

Sr. No.	Name of the Site	1971-72	1972-73	1977-78	1978-79	1979-80					
		Loan:GIA	Loan:G.I.A.	Lo-:G.I.A.	Lo-:G.I.A.	Loan :G.I.A.					
1	2	3	4	5	6	7	8	9	10	11	12
						an.		an.			
1.	Construction of Weekly Market.	20000	-	-	-	-	-	-	-	-	-
2.	Construction of Weekly Market and Mutton Market.	-	-	68300	9660	-	-	-	23750	-	-
3.	Development (Site No.19) of Playground.	-	-	-	-	-	28837	-	28837	-	32045
4.	Construction of community centre (Site No.21).	-	-	-	-	-	83100	-	83100	-	89425
5.	Construction of Public Latrines at two sites viz. 1) Choti Kunbi Ali 2) East of Pangregate	-	-	-	-	-	-	-	-	-	35200
6.	Construction of Primary School (Site No.1)	-	-	-	-	-	-	-	-	-	75000
7.	Construction of 12 Mtr. road from S.No. 17 to Hanuman Temple.	-	-	-	-	-	-	-	-	-	-
TOTAL :		20000	-	68300	9660	-	411937	-	135687	-	231670

Next columns continued on next page...

ANNUAL REPORT OF THE CORPORATION FOR THE YEAR 1983-84

Sr. No.	Name of the Site	1980-81		1981-82		1982-83		Total	
		Lo-an	G.I.A.	Lo-an	G.I.A.	Lo-an	G.I.A.	Lo-an	G.I.A.
1	Construction of Weekly Market.	-	36300	-	-	-	-	20000	36300
2	Construction of Weekly Market and Mutton Market.	-	-	-	-	-	-	68300	33410
3	Development (Site No.19) of Playground.	-	15400	-	-	-	-	-	105119
4	Construction of community centre (Site No.21.)	-	102300	-	-	-	-	-	357925
5	Construction of Public Latrines at two sites viz. 1) Choti Kunbi Ali 2) East of Pangre gate	-	45800	-	-	-	-	-	181000
6	Construction of Primary School (Site No.1)	-	-	-	100000	-	304100	-	479100
7	Construction of Mtr. road from S.No. 17 to Hanuman Temple	-	36300	-	-	-	-	-	36900
TOTAL		-	236700	-	100000	-	304100	88300	1129754

1982

67

35

1983

PAITHAN

1. NAME OF TOWN : Paithan.
2. GEOGRAPHICAL LOCATION AND ADMINISTRATIVE FUNCTIONS. : Latitude - 18° 39' N  
Longitude - 75° 26' E

Paithan is a Municipal Town administered by a 'C' class Municipal Council. It is the headquarters of Paithan Tahsil in Aurangabad District. It is situated about 53 kms. south of Aurangabad on the right bank of the Godavari river. The nearest railway station is Aurangabad. Paithan is about 97 kms north of Ahmednagar. Paithan Municipality/  
/was constituted in 1943 and is now governed under the Maharashtra Municipalities Act, 1965. The area under its jurisdiction is 501.76 hectares.

3. GEOGRAPHICAL AND PHYSICAL FEATURES :

Generally West and South part of Paithan town falls in a flat terrain. However, the main part of the town is situated on a hill. Ahmednagar - Aurangabad, the State Highway passes through the town. The physical aspects of the town are as under:-

i) Altitude - 451.3 m above, M.S.L.

ii) Rainfall - 960.0 mm

iii) Temperature

(a) Maximum - 43.3° c

b) Minimum - 27.0° c

The climate of the town is generally dry and healthy.

4. BRIEF HISTORY : Paithan is said to have been the capital of Shalivahana dynasty as early as back as in 77 A.D. It was then a very prosperous town under their rule. It was a great emporium of trade and remained so till the time it was the capital town.

Since quite early times Paithan has been a religious centre of great importance and has been the birth-place of many noted saints such as Shri Bhanudas, Mukteshwar etc. who are highly revered even to-day.

In the latter history, Paithan was under the control of king of Bijapur and at the end of eighteenth century it was under Maratha rule. Paithan of the present day occupies a very small portion of the ancient town and almost all traces of the latter have disappeared.

5. DEMOGRAPHY :

a) Population:

	1941	1951	1961	1971	1981
	7167	7293	8556	14526	21126

b) Decadal variation(%)

	1941-1951	1951-1961	1961-1971	1971-1981
	1.76	11.32	69.78	45.43

c) Sex Ratio (Females per 1000 Male Population.)

- i) 1971 - 888
- ii) 1981 - 967

d) Labour Participation Rate : i) Percentage of Total Workers to total population as per 1971 Census. - 28.45

ii) Percentage of main workers to total population as per 1981 Census. - 30.58

e) Occupational Structure :  
Structure

I) As per 1971 Census

Sr. No.	Category	Workers		% of workers to total workers.
		Males	Females	
1	2	3	4	5
1.	Cultivators	418	33	
2.	Agricultural Labourers	561	407	
3.	Livestock, Forestry, Fishing, Hunting, Plantation, Orchards etc.	166	1	
4.	Mining & Quarrying	-	1	
I TOTAL -PRIMARY SECTOR		1145	442	38.41
5.	Manufacturing, Processing, Servicing and Repairs			
	a) Household Industries	153	9	
	b) Other than Household Industries.	260	4	
6.	Construction	394	100	
II. TOTAL SECONDARY SECTOR		807	113	22.26

Contd...



Contd.,...

Sr. No.	Category	Workers		% of workers to total workers.
		Males	Females	
1	2	3	4	5
7.	Trade & Commerce	612	21	
8.	Transport, Storage & Communications.	97	7	
9.	Other Services	763	125	
III. TOTAL TERTIARY SECTOR		1472	153	39.33
TOTAL WORKERS I+II+III		3424	708	100.00

II - As per 1981 Census

1	2	3	4	5
1.	Cultivators(I)	470	73	8.13
2.	Agricultural Labourers(II)	769	821	23.82
3.	Household Industry, Manufacturing Processing, Servicing & Repairs(V(a))	149	55	3.06
4.	Other Workers(III, IV, V(b), VI to IX)	3660	451	61.58
5.	Total Main Workers(I to IX)	5048	1400	96.60
6.	Marginal Workers	94	133	3.40
7.	Total Workers(Sr.No.5+6)	5142	1533	100.00

f) Disabled population by type of Disability (1981 Census)

<u>Totally Blind</u>	<u>Totally Crippled</u>	<u>Totally Dumb</u>
6	10	-
<u>Total No. of Physically Handi-</u>		
<u>-capped.</u>		
16		

g) Age Structure :  
(As per 1971  
Census)

AGE GROUPS				
0-14	15-39	40-59	60 & above	Age not stated
5937	5631	2141	808	9

h) Literacy (%)

Census Year	Males	Females	Total
1971	56.65	28.97	43.76
1981	63.08	39.03	51.26

i) Town Density : i) 1971 - 29 persons per Hectare  
Census  
ii) 1981 - 42 Persons per Hectare  
Census

6. AVAILABILITY :  
OF PHYSICAL  
INFRASTRUCTURE  
(1981-82)

a) i) No. of Households : 3828  
(As per 1981  
Census)

ii) No. of Occupied Residential Houses (As per 1981 Census) : 3803

b) Water Supply : The Municipal Council has provided the town with tap water supply by tapping the Godavari river near Nath Mandir and Chlorinated piped water supply is available to the town. The daily per capita water supply is about 120 litres.

i) No. of Public Stand - 45 Posts.

ii) No. of Household - 1520 connections.

- c) Drainage : Underground drainage system is not provided to the town. At present surface drainage system (open gutters along roads) is in operation. The length of pucca gutters is 1405 mtrs. and that of kutchra gutters is 710 Mtrs.
- d) Electricity : The electricity is supplied to the town by Maharashtra State Electricity Board. The sub-station Jayakwadi is situated 8 km. away from the town.
- e) Transport and Communications : I) Transport -  
A) Rail - The town is not connected by Railway. The nearest railway station is Aurangabad. Paithan is connected by  
B) Roads -  
i) External - Paithan is connected by the following State Highways -  
1) Ahmednagar-Paithan-Aurangabad  
2) Paithan-Pachod-Ambad-Ghansawangi-Pimpalgaon.  
ii) Internal -  
Following are the main internal roads -  
1) Bazar Road  
2) Post Office Road  
3) Shivaji Statue to Old Nagar Road  
4) Kangar Hati to Bharat Talkies Road.  
The typewise road length is as under -  
1) Asphalted - 3.95 km.  
2) W.B.M. - 4.35 km.  
3) Others - 7.58 km.  
TOTAL - 15.83 km.  
The average road width is about 4.6 mtrs.

- iii) Availability of City/Town Buses for Intracity/Town movement - The facility of city bus service is not provided to the town.

II) Communication -

- i) No. of Telephone connections - 102
- ii) No. of Post Offices - 2
- iii) No. of Telegraph Offices - Nil
- iv) No. of Post Offices having Telegraph facility - 1

f) Fire Service : The fire service is not made available to the town by the Municipal Council.

7. AVAILABILITY OF SOCIAL INFRA-STRUCTURE

a) Education(1982-83)

The Primary Schools are run by the Zilla Parishad and Private Institutions.

F) Primary -

- i) No. of pre-primary schools - Nil
- ii) No. of Students in pre-primary Schools - Nil
- iii) No. of Primary Schools - 8
- iv) No. of Students in Primary Schools - 3121
- v) No. of Primary Schools in own premises - 5
- vi) No. of Primary Schools in hired premises - 3
- vii) No. of Primary Schools having playground facility - 4

II) Secondary -

- i) No. of Secondary Schools - 4  
(Z.P.-2,  
Private - 2)
- ii) No. of Students in  
Secondary Schools. - 2478
- iii) No. of Secondary Schools  
in own premises. - 2
- iv) No. of Secondary Schools  
in hired premises. - 2
- v) No. of Schools having  
playground facility. - 4

III) Higher-

- i) No. of Colleges - 2 ((1) Arts,  
Science & Commr. &  
(2) Basic Train  
-ing College)
- ii) No. of Students - 784 (Arts,  
Science & Commr.)  
- 76 (Basic Train  
-ing College)
- iii) No. of Colleges having  
playground facility. - 2

IV) Technical -

- i) No. of Institutes - 2
- ii) No. of Students - 45

b) Health (1981-82)

- i) No. of Public Dispen-  
saries. - 1 (including  
(One Health U  
Unit.)

- 1) (a) No. of Beds in Health Unit. - 28
- ii) a) No. of Public Hospitals - Nil
- b) No. of Beds in Public Hospital. - Nil
- iii) a) No. of Maternity Homes - Nil
- b) No. of beds in Maternity Homes. - Nil
- iv) No. of Veterinary Dispensaries. - 1 (Run by Z.P.)
- v) No. of Public Latrines. - 22 (Seats -106)
- vi) No. of Slums/Zopadpatties - Nil
- vii) Slum Population residing in slum areas or zopadpatties. - Nil
- c) Recreational Facilities and Amenities (1981-82)
- i) No. of Parks & Gardens - 1 Garden  
Park-Nil.
- ii) No. of clubs - Nil
- iii) No. of Public Libraries - 1
- iv) No. of Public Playgrounds - Nil
- v) No. of Public Meeting Places - Nil
- vi) Availability of open space (Per 1000 Population)(\*) - Nil  
(As per 1981 Census.)
- vii) No. of Cinema Theatres - 1
- viii) No. of Drama Theatres - Nil
- ix) No. of Swimming pools - Nil
- x) No. of Gymnasia - 3

(\*) Note :- Open Space includes the area of Public playgrounds and public meeting places.

8. OTHER FACILITIES:  
IN THE TOWN/CITY  
(1981-82)

- a) Agricultural Produce Market Yard. : The Agricultural Produce Market Committee was established under the Hyderabad Agricultural Produce Market Act, 1930. The area of Market extends within a radius of 5 miles around the Tahsil Office. The Agricultural Produce Market Committee has brought under its regulation the commodities like wheat, jowar, bajra, gram, math, tur, moong, kulthi, karadi, linseed, till, gur, cotton, ambadi, castor-seeds and monari. The total number of commodities regulated is 54.
- b) Weekly Market : The Weekly bazar is held on every Friday at Yatra Maidan.
- c) Vegetable Market : There is one vegetable Market in the town. It admeasures an area of about 46.4 sq.mtrs.
- d) Fish & Mutton Market : There is one constructed Fish and Mutton Market (Area - 40 Sq.Mtrs.)
- e) No.of Organised Shopping Centres. : Nil
- f) No.of Banks : 5 (Nationalised-3 and Cooperative-2)
- g) No.of Registered Shops/Establishments. : Nil
- h) No.of Police Stations : 1
- i) No.of Police Out Posts: Nil

9. INDUSTRIES  
IN THE TOWN  
(1981-82)

: As per 1971 Census the functional classification of the town is Primary and Industry. Shri. Sant Eknath Sahakari Sakhar Karkhana Ltd. and M/s Jain Spinners Ltd. are the two major industrial establishments which provide employment to about 1200 persons. No other notable industries are functioning in the town. There are, however, six saw mills and one paper mill.

10. INCOME AND  
EXPENDITURE OF  
PAITHAN MUNICIPAL  
COUNCIL (1981-82)

I) Income

- a) Total Tax Revenue : Rs.678765
- b) Per Capita Tax Revenue : Rs.32.13  
(As per 1981 Census)
- c) Total Non-Tax Revenue : Rs.853703  
(inclusive of grants and loans)
- d) Per Capita Non-Tax Revenue (inclusive of grants and loans) : Rs.40.41
- e) Total Income (inclusive of opening balance) : Rs.1696457
- f) Per Capita Total Income : Rs.8030  
(As per 1981 Census)

II) Expenditure

- a) Total Expenditure : Rs.1461675
- b) Per Capita Total Expenditure (As per 1981 Census) : Rs.69.19



11. BREAK UP  
OF LAND USE  
(As per Dev.Plan)

(Area in Hectarâs)

Sr.: No.	Type	Area as :	
		per existing land-use	Area as per propo- sed Landuse
	Reference Year	1971	1991
1.	Residential	57.07	184.44
2.	Commercial	7.04	18.00
3.	Industrial	2.00	2.00
4.	Public & Semi-Public	16.93	68.85
5.	Public Utilities	0.70	0.70
6.	Garden and Playgrounds	25.98	48.16
7.	Transport and Communications	28.95	38.25
8.	Agriculture	105.45	10.76
9.	Water Bodies	130.60	130.60
10.	Vacant and Barren lands	127.04	-
	Total :	501.76	501.76

12. DEVELOPMENT PLAN :

- a) Date of sanction of Development Plan. : 1-7-1972
- b) Projected Population for the year 1991. : 13000  
(As per Development Plan)
- c) Town Planning Scheme, if any, sanctioned : Nil

d) Financial assistance so far released  
for the implementation of Development Plan.

Sr. No.	Name of the Site : 1973-74		: 1975-76		: 1977-78		: 1978-79		: 1979-80		
	: Loan:G.I.A.		: Loan :G.I.A.		:Lo-:G.I.A.		:G.I.A.		:Lo-: G.I.A.		
1	2	3	4	5	6	7	8	9	10	11	12
1.	Construction of 6 roads.	74943	-	74973	-	-	-	-	-	-	-
2.	Construction of community centre in site No.16.	-	-	-	-	-	169200	-	29466	-	21300
3.	Development of Garden in Site No.1.	-	-	-	-	-	30383	-	-	-	20000
4.	Construction of 18 metre Dev.Plan road from Swar Shivaji statue to old Nagar Rd.	-	-	-	-	-	-	-	65050	-	50000
5.	Construction of Public Latrines Bharat Theatre.	-	-	-	-	-	-	-	-	-	21600
6.	ISM, road from Kanger Hatti to Bharat Talkies.	-	-	-	-	-	-	-	-	-	-
7.	Construction of Public Latrines at 2 Sites.	-	-	-	-	-	-	-	-	-	-
TOTAL		74943	-	74973	-	-	199583	-	94516	-	112900

Next colmns.continued  
on next page.....

Contd....

Sr. No.	Name of the Site	1980-81		1981-82		1982-83		Total	
		: Loan	: G.I.A.	: Loan	: G.I.A.	: Loan	: G.I.A.	: Loan	: G.I.A.
1	2	13	14	15	16	17	18	19	20
1.	Construction of 6 roads.	-	-	-	-	-	-	149916	-
2.	Construction of community centre in Site No.16.	-	103000	-	150000	-	345100	-	818066
3.	Development of Garden in Site No.1.	-	70000	-	-	-	-	-	120383
4.	Construction of 18 metre Dev.Plan road from Swar Shivaji statue to old Nagar Rd.	-	18600	-	-	-	-	-	133650
5.	Construction of public latrines Bharat Theatre.	-	-	-	-	-	-	-	21600
6.	ISM, road from Ranger Hatti to Bharat Talkies.	-	114000	-	-	-	-	-	114000
7.	Construction of Public Latrines at 2 Sites.	-	36600	-	-	-	-	-	36600
TOTAL :		-	342200	-	150000	-	345100	149916	1244299

1  
8  
1

VAIJAPUR

1. NAME OF TOWN : Vaijapur
2. GEOGRAPHICAL LOCATION AND ADMINISTRATIVE FUNCTIONS : Latitude -  $19^{\circ} 56'$  N  
Longitude -  $74^{\circ} 46'$  E

It is a 'C' Class Municipal town and the headquarters of the tahsil of the same name. The town is connected by Nashik-Manmad-Aurangabad State Highway. Rotegaon Railway Station is the nearest Railway Station and it is 5 kms. away from this town. Vaijapur Municipal Council was established in 1944 and is now governed under the Maharashtra Municipalities Act, 1965. The area under its jurisdiction is 469.7 hectares.

3. GEOGRAPHY AND PHYSICAL FEATURES

Vaijapur is situated on the Narangi river. There is a confluence of Narangi and Sarangi river towards the west of this town. Vaijapur gaon is founded on the slope towards Narangi river. The soil of this town is mostly of a black cotton type.

i) Altitude - 533.0 Mtrs. above M.S.L.

ii) Rainfall - 572.8 mm.

iii) Temperature

a) Maximum -  $40.4^{\circ}$  c  
 ~~$45.6^{\circ}$~~

b) Minimum -  $6.8^{\circ}$  c  
 ~~$70.0^{\circ}$~~

The climate of Vaijapur town is generally dry and healthy.

4. BRIEF HISTORY

: The town has no historical importance.

The following excerpt from the District Gazetteer throws light on the origin of this town.

"Regarding the origin of Vaijapur which was also known as Baizapur, it is related that a certain Kunbi struck upon a linga while ploughing his field. He installed this linga in a temple to Vaijanath and hence the village came to be known as Vaijapur. Yet another story tells that a certain princess Vaija was converted by a Muhammedan Saint and that after her death she was laid to rest in the tomb of that Saint. To commemorate this event the village was termed as Vaijapur or Baizapur."

5. DEMOGRAPHY :

a) Population:

1941	1951	1961	1971	1981
8507	10363	13878	16660	20657

b) Decadal variation (%)

1941-51	1951-61	1961-71	1971-81
21.82	33.92	20.05	23.97

c) Sex Ratio : (Females per 1000 Males population)

- i) 1971 Census - 866
- ii) 1981 Census - 926

d) Labour Participation Rate

- i) Percentage of total workers to total population as per 1971 Census. - 28.76
- ii) Percentage of Main Workers to Total population. - 28.07

e) Occupational Structure

I) As per 1971 Census

Sr. No.	Category	Workers		% of workers to total workers.
		Males	Females	
1	2	3	4	5
1.	Cultivators	373	44	8.70
2.	Agricultural Labourers	177	176	7.36
3.	Livestock, Forestry, Fishing, Hunting, Plantations, Orchards etc.	93	22	2.40
4.	Mining and Quarrying	-	-	-
I) TOTAL - Primary Sector		643	242	18.46
5.	Manufacturing, Processing Servicing and Repairs.			
a)	Household Industries	177	60	4.94
b)	Other than Household Industries.	630	108	15.39
6.	Construction	153	16	3.53
II) TOTAL - Secondary Sector		960	184	23.86
7.	Trade and Commerce	995	53	21.86
8.	Transport, Storage and Communications.	251	-	5.24
9.	Other Services	1178	288	30.58
III) TOTAL - Tertiary Sector		2424	341	57.68
TOTAL WORKERS (I + II + III)		4027	767	100.00

II) As per 1981 Census

Sr. No.	Category	Workers		% of workers to total workers
		Males	Females	
1	2	3	4	5
1.	Cultivators (I)	389	78	7.79
2.	Agricultural Labourers(II)	406	369	12.93
3.	Household Industry, Manufacturing Processing, Servicing & Repairs(V(a))	192	170	6.04
4.	Other Workers(III,IV, V(b), VI to IX)	3724	471	70.02
5.	TOTAL MAIN WORKERS	4711	1088	96.78
6.	MARGINAL WORKERS	68	125	3.22
7.	TOTAL WORKERS (Sr.No.5+6)	4779	1213	100.00

f) Disabled Population by type of Disability (1981 Census)

<u>Totally Blind</u>	<u>Totally Crippled</u>	<u>Totally Dumb</u>
7	7	1
<u>Total No. of Physically Handi-</u> <u>-capped.</u>		
15		

g) Age Structure (As per 1971 Census)

Age Groups			
0-14	15-39	40-59	60 and above
7087	6556	2227	788
Age not stated			
2			

h) Literacy (%) :

Census Year	Males	Females	Total
1	2	3	4
1971	62.95	32.97	49.03
1981	67.09	44.38	56.16

i) Town Density : i) 1971 - 35 Persons per  
Census Ha.

ii) 1981 - 44 Persons Per  
Census Ha.

6. AVAILABILITY  
OF PHYSICAL  
INFRASTRUCTURE  
(1981-82)

a) i) No. of : 3568  
Households  
(As per 1981  
Census)

ii) Number of : 3557  
occupied Residen-  
tial Houses  
(As per 1981  
Census)

b) Water Supply : Chlorinated piped water supply is made to the town. A small bund is constructed on river Sarangi from where the water is pumped and then stored in a high level tank for distribution. Similarly water is taken for supply from Godavari left bank canal. The daily per capita water supply is about 45 litres. There are 45 private wells and 12 Public Wells in the Town. The residents also use water from these wells for drinking purpose.



- i) No. of Public Stand Posts - 57
- ii) No. of Household connections. -1693

c) Drainage : Underground drainage system is not introduced in the town. There is open drainage system existing in the town. The length of open pucca gutters is 17000 metres and that of kutchha gutters is 5000 metres.

d) Electricity : The electricity supply is provided to the town by the Maharashtra State Electricity Board through its sub-station, Vaijapur situated at a distance of 7/2 km. away from the town.

e) Transport & Communications (1981-82)

i) Transport -

A) Rail - Vaijapur town is not connected by railway. The nearest Railway station is at Rotegaon on Mannad-Secunderabad Metre guage railway line of the South-Central Railway and it is 5 km. away from Vaijapur.

B) Roads - i) External-  
The Town is connected by the following State Highways :-

- 1) Nashik - Nirmal (No.6 A)
- 2) Shivar - Malegaon (No.16)

Similarly the following Major District roads either pass through or emnate from Vaijapur.

- 1) Tembhi-Nagmathan Road
- 2) Vaijapur-Savarkheda Road
- 3) Vaijapur-Belgaon Road
- 4) Vaijapur-Lasur Road
- 5) Vaijapur-Gangapur Road
- 6) Vaijapur-Deogaon Road.

ii) Internal - Following are the main internal roads of Vaijapur Town.

- 1) Tilak Road
- 2) Shivaji Road
- 3) Maharana Pratap Road
- 4) Police Station Road
- 5) Dak Bunglow Road.

The typewise road lengths of all internal roads are as under -

- |                     |   |           |
|---------------------|---|-----------|
| i) Asphalted        | - | 1.41 km.  |
| ii) Cement concrete | - | 2.00 km.  |
| iii) W.B.M.         | - | 4.56 km.  |
| iv) Other           | - | 6.24 km.  |
|                     |   | -----     |
| Total               | - | 14.21 km. |

The average road width is about 9 metres.

iii) Availability of City/Town Buses for Intracity/Town movement-

The facility of intracity bus service is not provided to the town.

II ) Communications -

- i) No. of Telephone connections - 146
- ii) No. of Post Offices - 2
- iii) No. of Telegraph Offices - Nil
- iv) No. of Post Offices having Telegraph facility. - 1

f) Fire Service - : The fire service is not available to the town.

7. AVAILABILITY :  
OF SOCIAL  
INFRASTRUCTURE

a) Education

I) Primary - Primary Schools are run by Zilla Parishad and Private Institutions.

- i) No. of Pre-primary Schools : 2
- ii) No. of students in Pre-Primary School. : 118
- iii) No. of Primary Schools : 19
- iv) No. of Students in Primary Schools. : 4680
- v) No. of Primary Schools in own premises. : 10
- vi) No. of Primary Schools in hired premises. : 9
- vii) No. of Primary Schools having playground facility. : 19

II) Secondary -

- i) No. of Secondary Schools : 5  
(Z.P.-2  
Private-3)
- ii) No. of Students in Secondary Schools. : 2623  
(Z.P.-1904,  
Private-719)
- iii) No. of Secondary Schools in own premises. : 4  
(Z.P.- 2,  
Private-2)
- iv) No. of Secondary Schools in hired premises. : 1  
Run by Private Institute.
- v) No. of Schools having playground facility. : 5

III) Higher -

- i) No. of Colleges - 2 ( One Arts, Science & Commerce and one Basic Training College.)
- ii) Total No. of College going students. - 1201
- iii) No. of Colleges having playground facility. - 2

IV) Technical -

- i) No. of Institutes - 2
- ii) No. of Students - 305

b) Health -

- i) No. of Public Dispensaries. - One
- ii) a) No. of Public Hospitals - One Primary Health Centre and Maternity Home.
- b) No. of Beds in Hospitals - General Ward - 12  
Maternity - 10  
Ward.
- iii) No. of Veterinary Dispensaries. - One (Run by Zilla Parishad)
- iv) No. of Public Latrines - 13  
(82 Seats)
- v) No. of slums/ Zopadpatties. - Nil
- vi) Slum Population residing in slum areas or Zopadpatties. - Nil

c) Recreational  
Facilities and  
Amenities -

- i) No. of Parks & Gardens - Parks - Nil  
Garden - Nil
- ii) No. of Clubs - 2
- iii) No. of Public Libraries - 1 (Run by Municipal  
Council)
- iv) No. of Public Playgrounds - Nil
- v) No. of Public Meeting  
Places. - 1 (Having an area  
of 4000 sq.mtrs)
- vi) Availability of Open  
Spaces (\*) - 194 Sq.Mtrs.  
(Per 1000 Population)  
As per 1981 (P)(Census)
- vii) No. of Cinema Theatres - 2
- viii) No. of Drama Theatres - Nil
- ix) No. of Swimming Pools - Nil
- x) No. of Gymnasias - Nil

Note: Open Space includes the area of public  
playgrounds and public meeting places.

8. OTHER FACILITIES !  
IN THE TOWN  
(1981-82)

- a) Agricultural Produce : The Agricultural Produce  
Market Yard Market Committee was  
established in the year  
1947. The Market Yard is  
centrally situated and  
comprises an area  
within a radius of five  
miles from the tahsil  
office. The jurisdiction  
of the market committee  
extends over the whole  
of Vaijapur tahsil. The  
Agricultural Produce  
Market Committee has

brought under its regulation 59 commodities. Important among them are cotton, lint, wheat, jowar, bajra, gram, linseed, groundnut, paddy, rice, tobacco, tur, mug, math, safflower, chilli, mustard, garlic, onion, lakh, watana, udid and gur.

- b) Weekly Market : The Weekly bazar is held on every Monday on the North side of the town.
- c) Vegetable Market : One. The Municipal Council has constructed some platforms (Ottas) for the purpose. It admeasures an area of about 10400 sq. Metres.
- d) Fish and Mutton Market. : Nil.
- e) No.of Organised shopping centres. : Nil
- f) No.of Banks : 5 (Out of 5 banks 2 are nationalised, 2 are co-operatives and one is commercial Bank).
- g) No.of Registered shops/establishments. : 507
- h) No.of Police Stations. : 1
- i) No.of Police Out Posts. : Nil

9. INDUSTRIES  
IN THE TOWN  
(1981-82)

: As per 1971 Census the functional classification of the town is Service, Industry and Commercial. In olden days the town had a considerable trade in the manufacture of silk which has all but

: dwindled in recent times. For the revival of this industry and establishing new ones, steps have been taken to set up an industrial estate. At present there are two Oil Mills, One Dal Mill and three Saw Mills functioning in Vaijapur Municipal Area. They are providing employment to 37 persons.

10. INCOME AND EXPENDITURE OF VAIJAPUR MUNICIPAL COUNCIL (1981-1982)

I) Income

- a) Total Tax Revenue : Rs.1071907
- b) Per Capita Tax Revenue : Rs. 51.89  
(As per 1981 Census)
- c) Total Non-Tax Revenue : Rs.8,38,541  
(inclusive of grants and loans and exclusive of extra-ordinary debts).
- d) Per Capita Non-Tax Revenue : Rs. 40.59  
(inclusive of grants, loans and exclusive of extra-ordinary debts).
- e) Total Income : Rs.23,73,065  
(inclusive of opening balance and excluding extraordinary debts)
- f) Per Capita Total Income : Rs.114.88  
(As per 1981 Census)

II) Expenditure

- a) Total Expenditure : Rs.19,45,071  
(excluding extraordinary debts)
- b) Per Capita Total expenditure (As per 1981 Census) : Rs. 94.16

11. BREAK UP  
OF LAND USE  
(As per Dev. Plan)

(Area in Hectares)

Sr. No.	Item	Area as per	
		existing land-use	Proposed land-use
Reference Year		1971	1991
1.	Residential	29.402	95.560
2.	Commercial	13.500	22.350
3.	Industrial	3.651	24.820
4.	Public & Semi Public	17.756	37.780
5.	Public Utilities	1.717	6.730
6.	Garden and Playgrounds	1.344	13.190
7.	Transport and Communi- cations.	29.045	32.010
8.	Agriculture	353.300	232.220
9.	Water Bodies	5.040	5.040
10.	Vacant and barren land.	14.945	-
Total:		469.700	469.700

12. DEVELOPMENT PLAN :

- a) Date of sanction of Development Plan. : 15.5.1974
- b) Projected Population for the year 1991 as per Development Plan. : 23000 souls.
- c) Financial Assistance so far released for implementation of the Development Plan. : Nil



d) Financial Assistance so far released for the implementation of Dev. Plan.

(Amount in Rs.)

Sr. No.	Name of the Site	1974-75		1976-77		1977-78		1978-79		1979-80		1980-81		1981-82		Total	
		Loan	GIA	Loan	GIA	Loan	GIA	Loan	GIA	Loan	GIA	Loan	GIA	Loan	GIA	Loan	GIA
1	2	3	4	5	6	7	8	9	10	11	12	13	14	15	16	17	18
1	Construction of vegetable market and shops(S.No.13)	62500	-	54520	-	8000	-	-	-	-	-	9000	-	11300	-	62500	145320
2	Acquisition of land for widening of D.P.road from State Highway to Datta Mandir.	-	-	-	-	105000	-	24000	-	-	-	-	-	-	-	129000	-
3	Construction of Public Latrines near Pirzada Mohalla & Weekly market.	-	-	-	-	-	-	-	-	35000	-	-	9000	-	11300	35000	20300
TOTAL :		62500	62500	54200	-	105000	8000	24000	-	35000	-	-	18000	-	22600	226500	165620

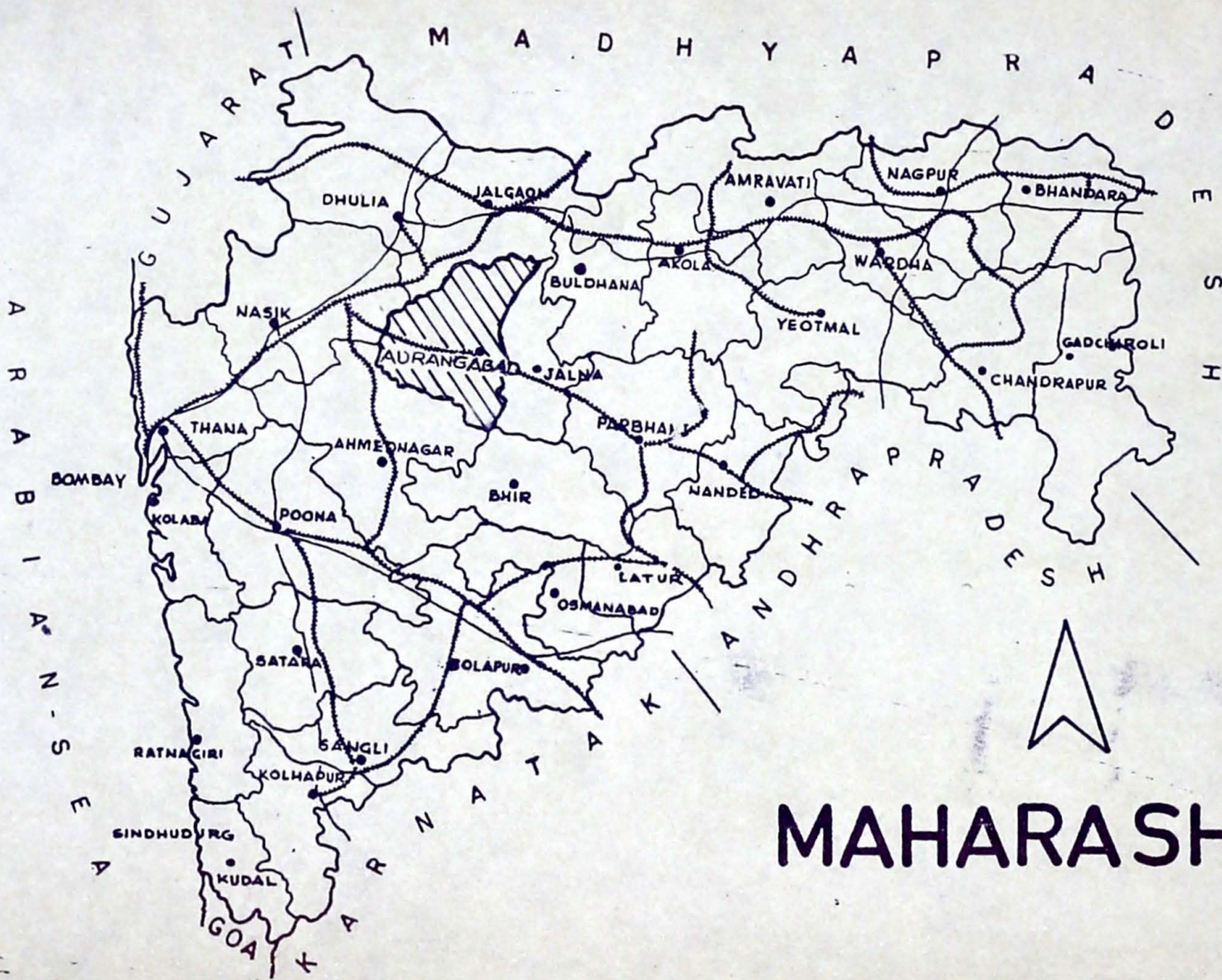

# MAHARASHTRA

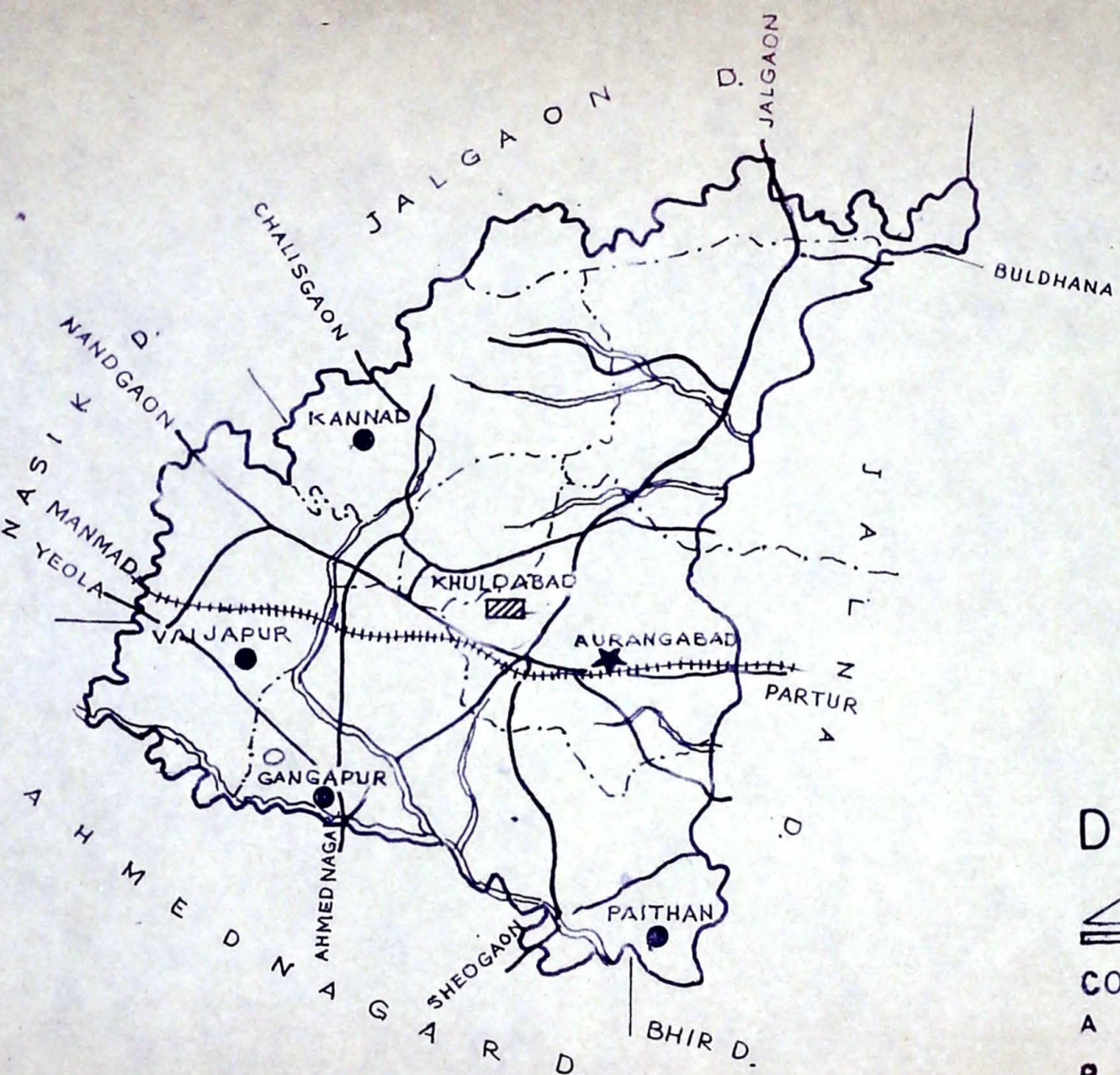

# DISTRICT AURANGABAD

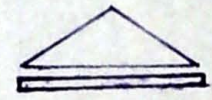

- CORPORATION - - - - - ★
- A CLASS MUNICIPAL COUNCIL - - - - - ■
- B CLASS MUNICIPAL COUNCIL - - - - - ▲
- C CLASS MUNICIPAL COUNCIL - - - - - ●
- HILL STATION MUPL. COUNCIL - - - - - ▨

IX

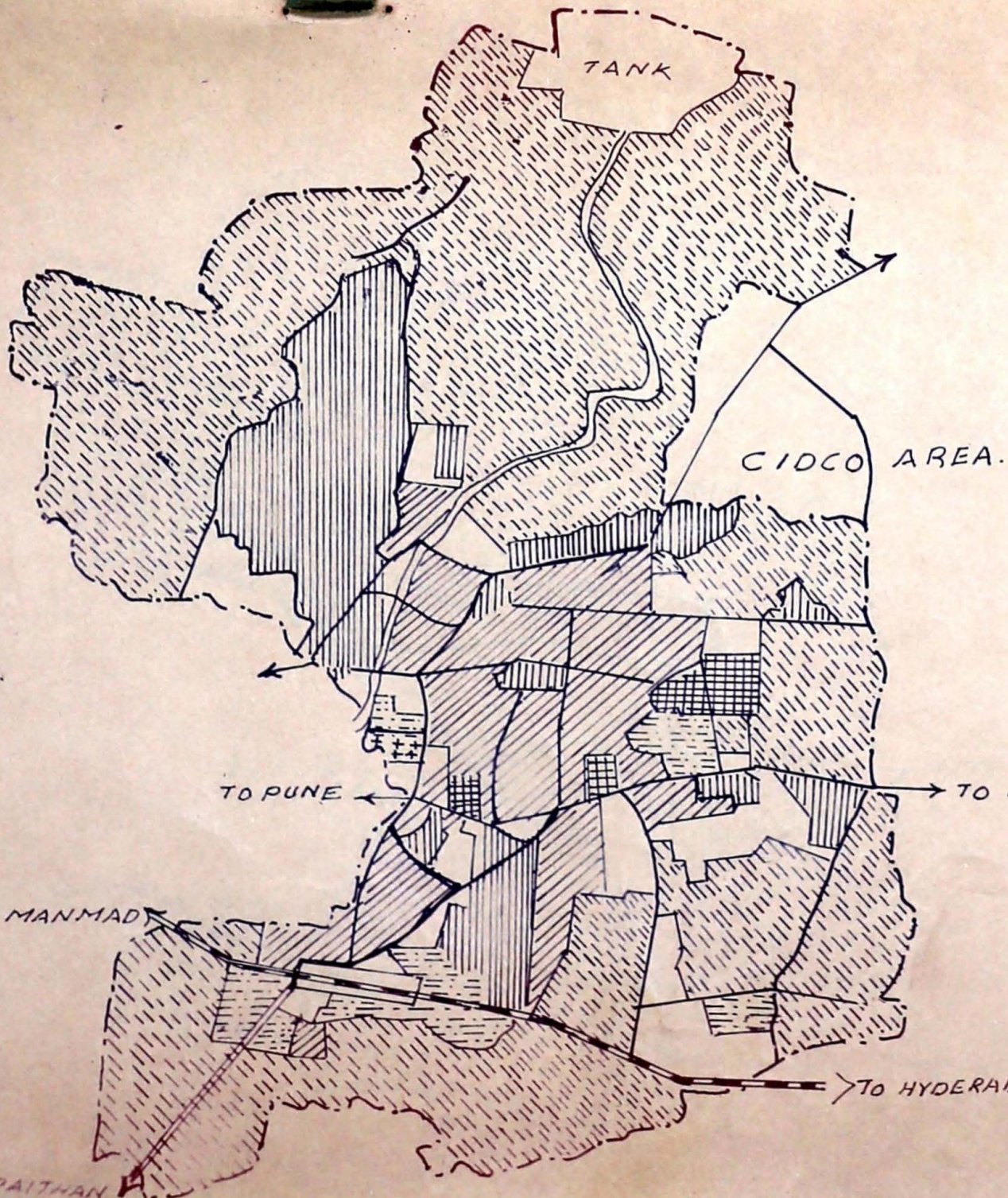

• **DEVELOPMENT PLAN OF AURANGABAD**  
 • existing land use map

• references:

- residential
- commercial
- industrial
- public & semipublic
- public utility
- transport
- open space, garden
- agricultural
- vacant land
- municipal limits



SCALE: - 1:32000

TANK

# DEVELOPMENT PLAN OF AURANGABAD proposed land use map

references:

-  residential
-  commercial
-  industrial
-  public & semipublic
-  public utility
-  transport
-  open space, garden
-  agricultural
-  water bodies
-  municipal limits

TO JALGAON

CIDCO AREA



SCALE: - 1:3200

TO PUNE  
TO BOMBAY

TO JALNA

TO MANMAD

TO HYDERABAD

TO RAITHAN

DEVELOPMENT PLAN SANCTIONED  
 VIDE U.D.P.H & M.D. RESOLUTION  
 NO. TPs/3073/4958-W-II  
 DATED 6-1-1975 TO COME IN TO  
 FORCE FROM 1-3-1975

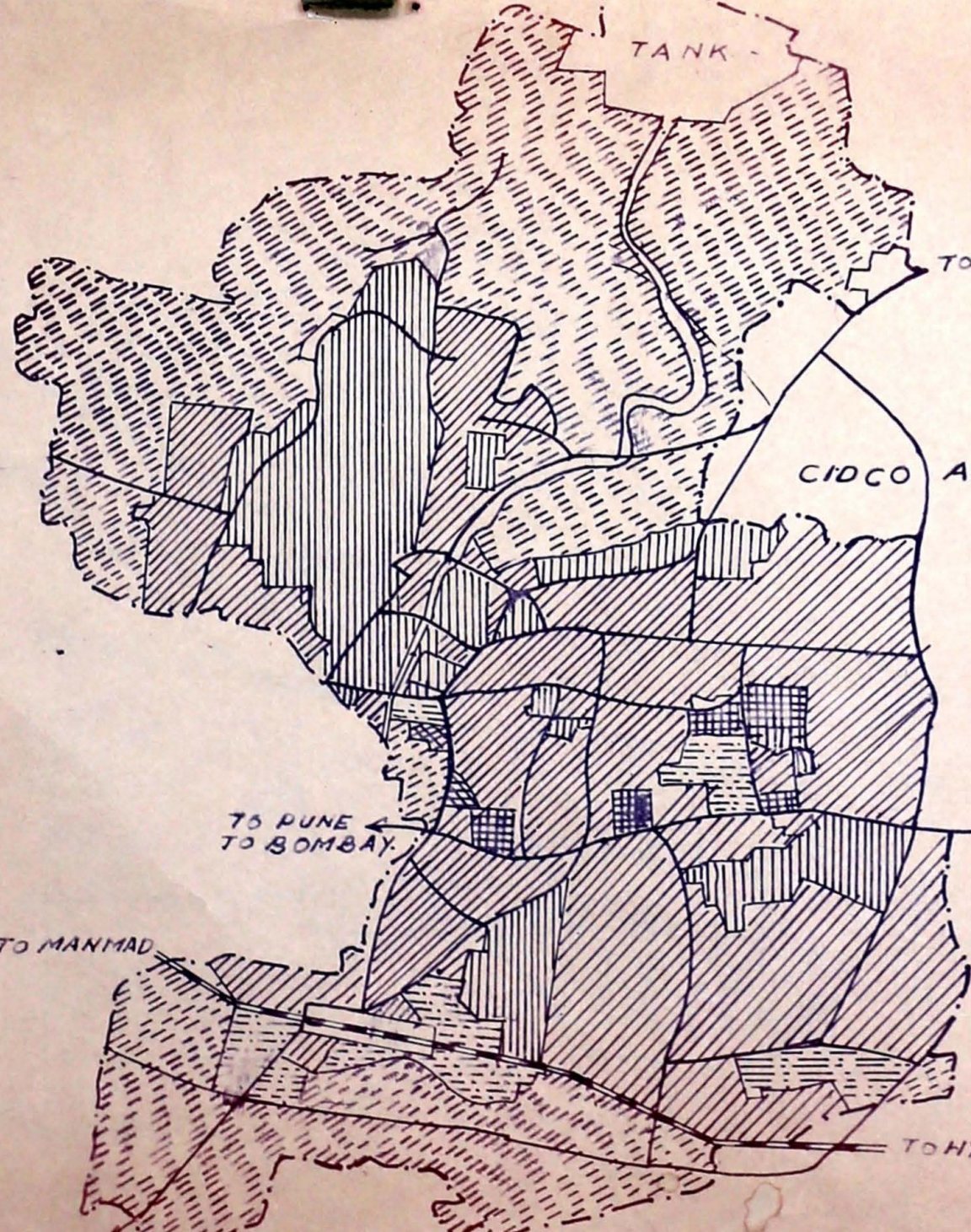

- DEVELOPMENT PLAN OF GANGAPUR
- existing land use map
- references:
- residential
- commercial
- industrial
- public & semipublic
- vacant land
- transport
- smashan bhoomi
- agricultural
- water bodies
- municipal limits

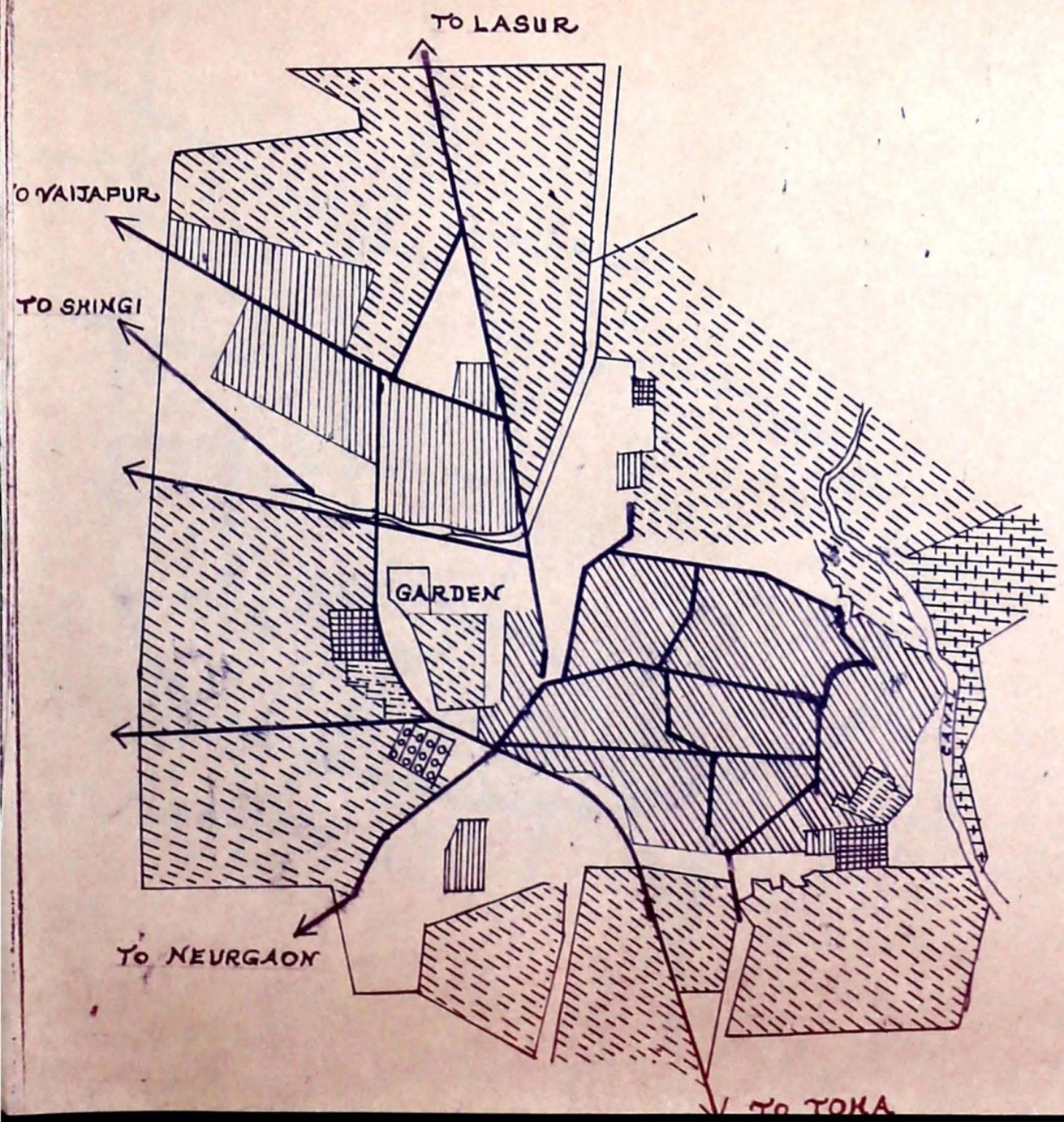
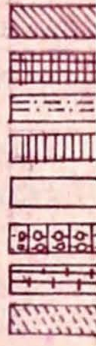

↑  
TO LASUR

200

TO VAITAPUR

K  
TO SHINGI

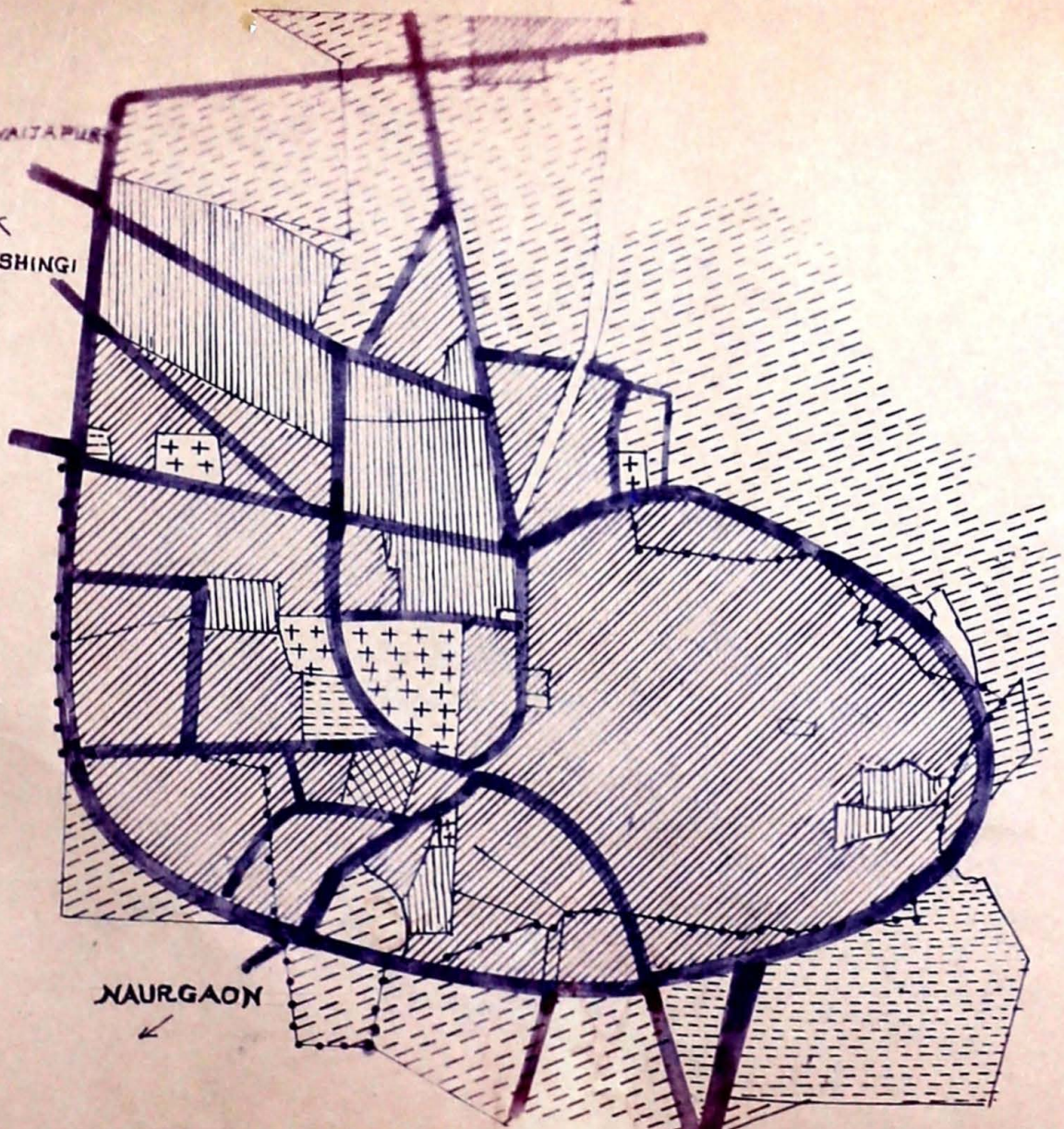

• DEVELOPMENT PLAN  
OF GANGAPUR  
proposed land use map

- references:
- residential
- commercial
- industrial
- public & semipublic
- public utility
- transport
- open space, garden
- agricultural
- water bodies
- municipal limits

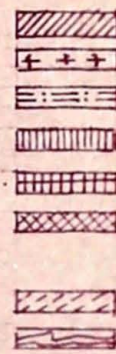

DEVELOPMENT PLAN SANCTIONED  
VIDE U.D.P.H. & H.D. RESOLUTION  
NO TPS 3071/21810 - W-II DATED  
1-4-72 TO COME IN TO FORCE  
FROM 1-6-1972

NAURGAON  
↙

TO JALGAON

• **DEVELOPMENT PLAN OF KANNAD**

• existing land use map

• references:

- residential
- commercial
- industrial
- public & semipublic
- public utility
- transport
- open space, garden
- agricultural
- vacant land
- municipal limits

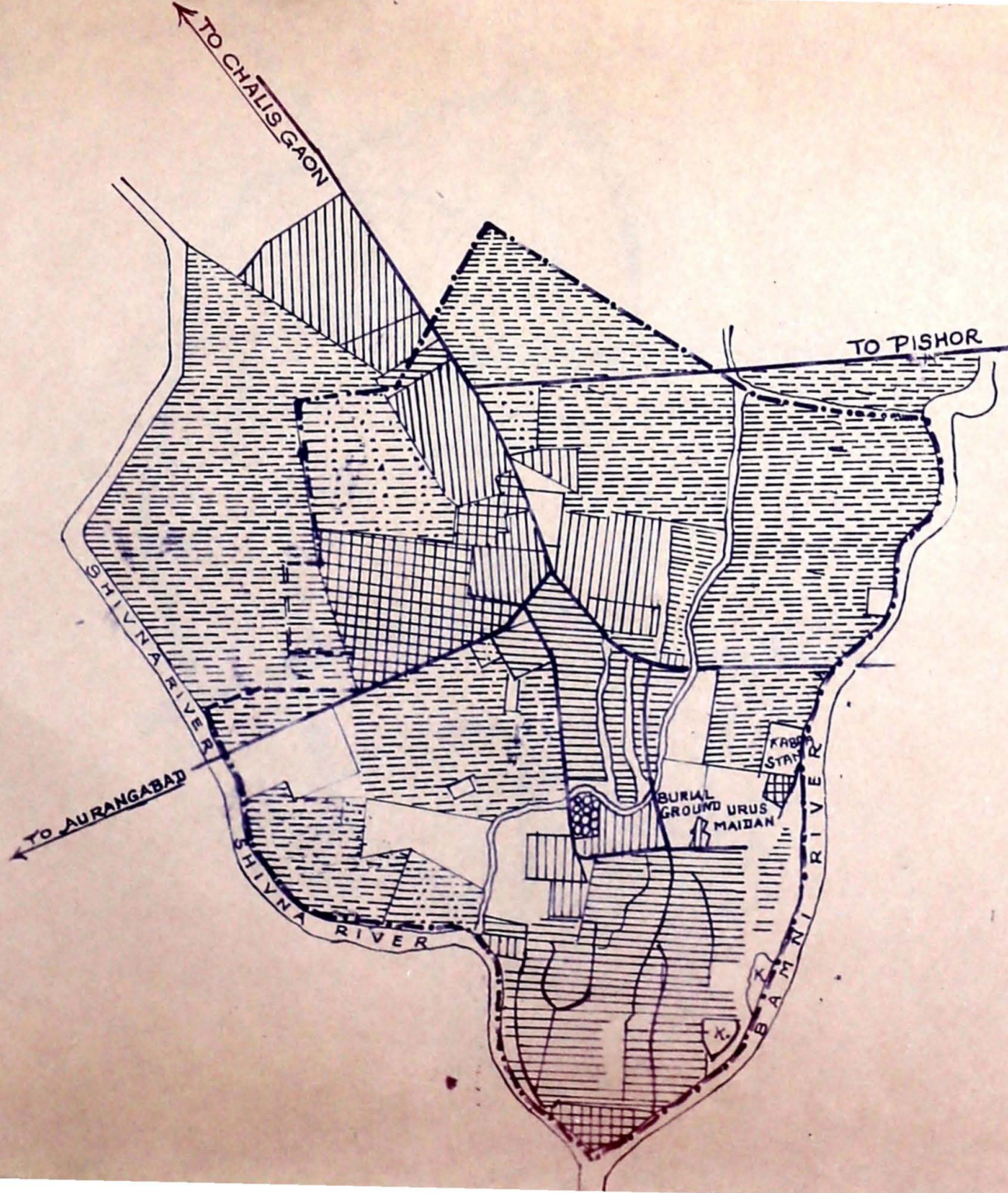

SCALE 1 - 1



TO CHALIBGAON

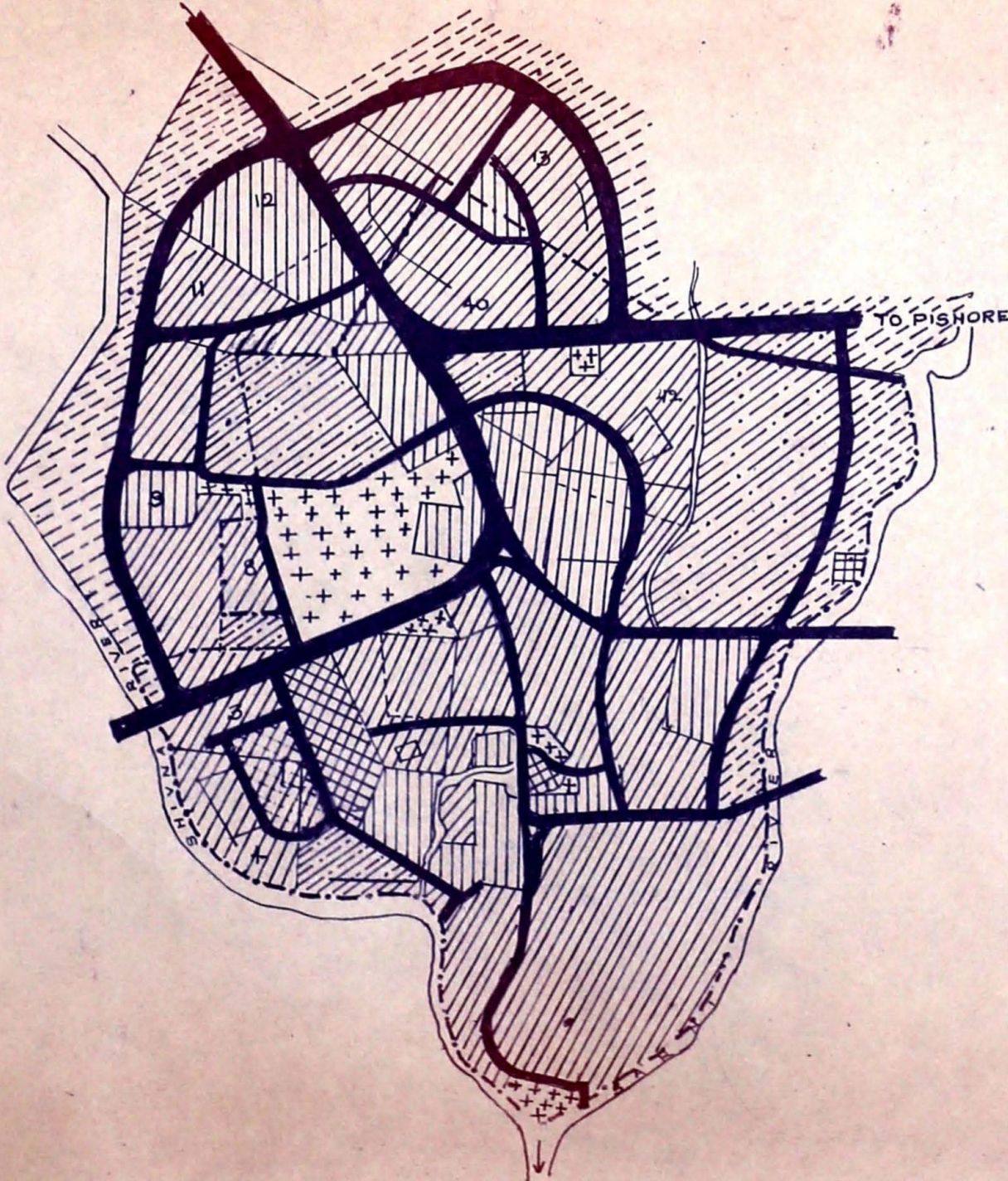

• DEVELOPMENT PLAN  
OF KANNAD  
proposed land use map

• references:

- residential
- commercial
- industrial
- public & semipublic
- public utility
- transport
- open space, garden
- agricultural
- water bodies
- municipal limits



NOTE: DEVELOPMENT PLAN

SANCTIONED VIDE U.D.P. H. & H.D.  
RESOLUTION NO.TPS/3074/56423-  
W-II DATED 13-1-1975 TO COME INTO  
FORCE FROM 1-3-1975

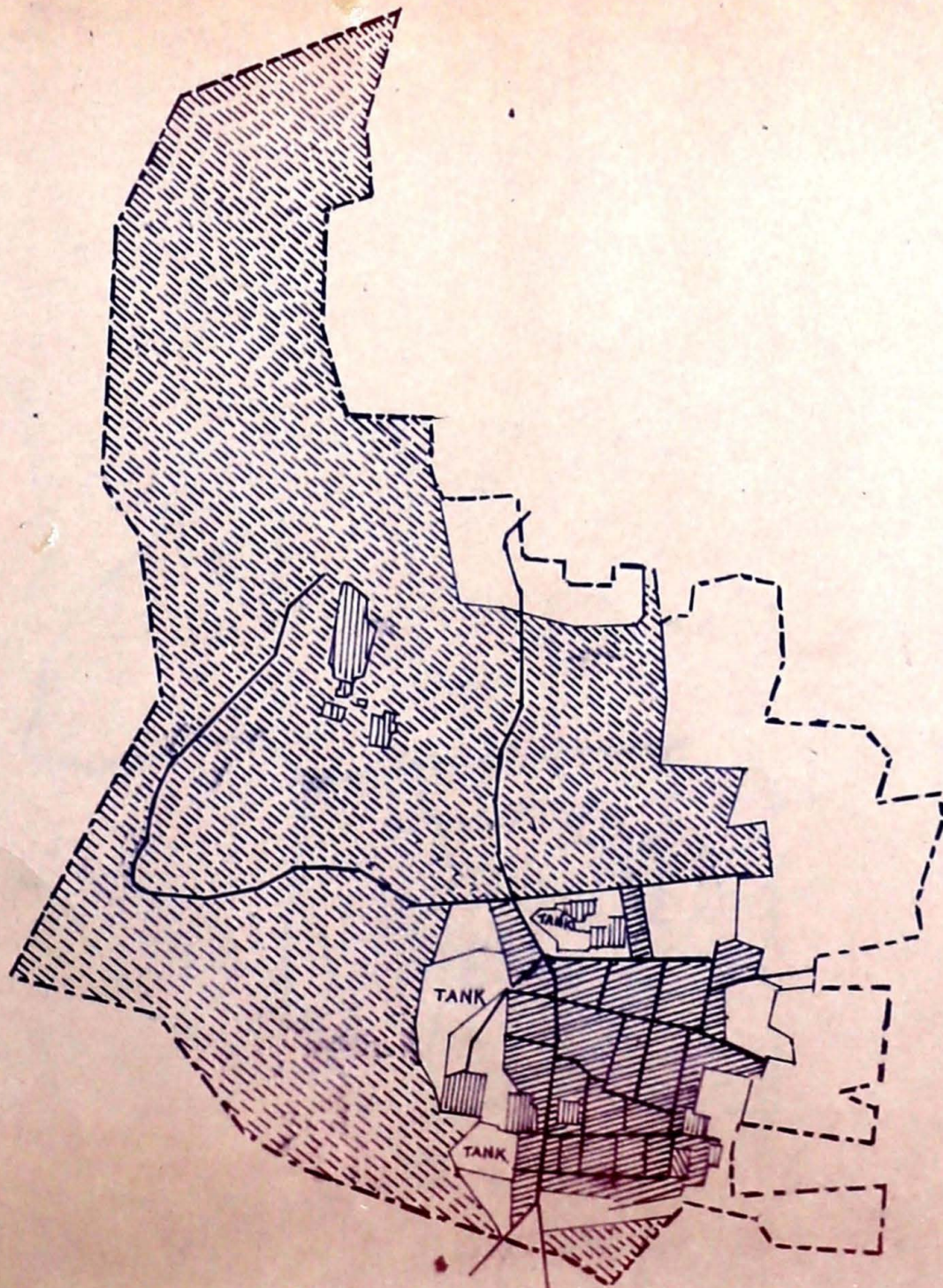

- DEVELOPMENT PLAN OF KHULTABAD
- existing land use map
- references:
- residential
- commercial
- industrial
- public & semipublic
- vacant land
- transport
- open space, garden
- agricultural
- water bodies
- municipal limits

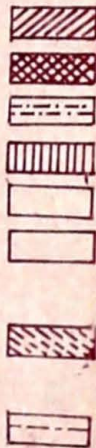

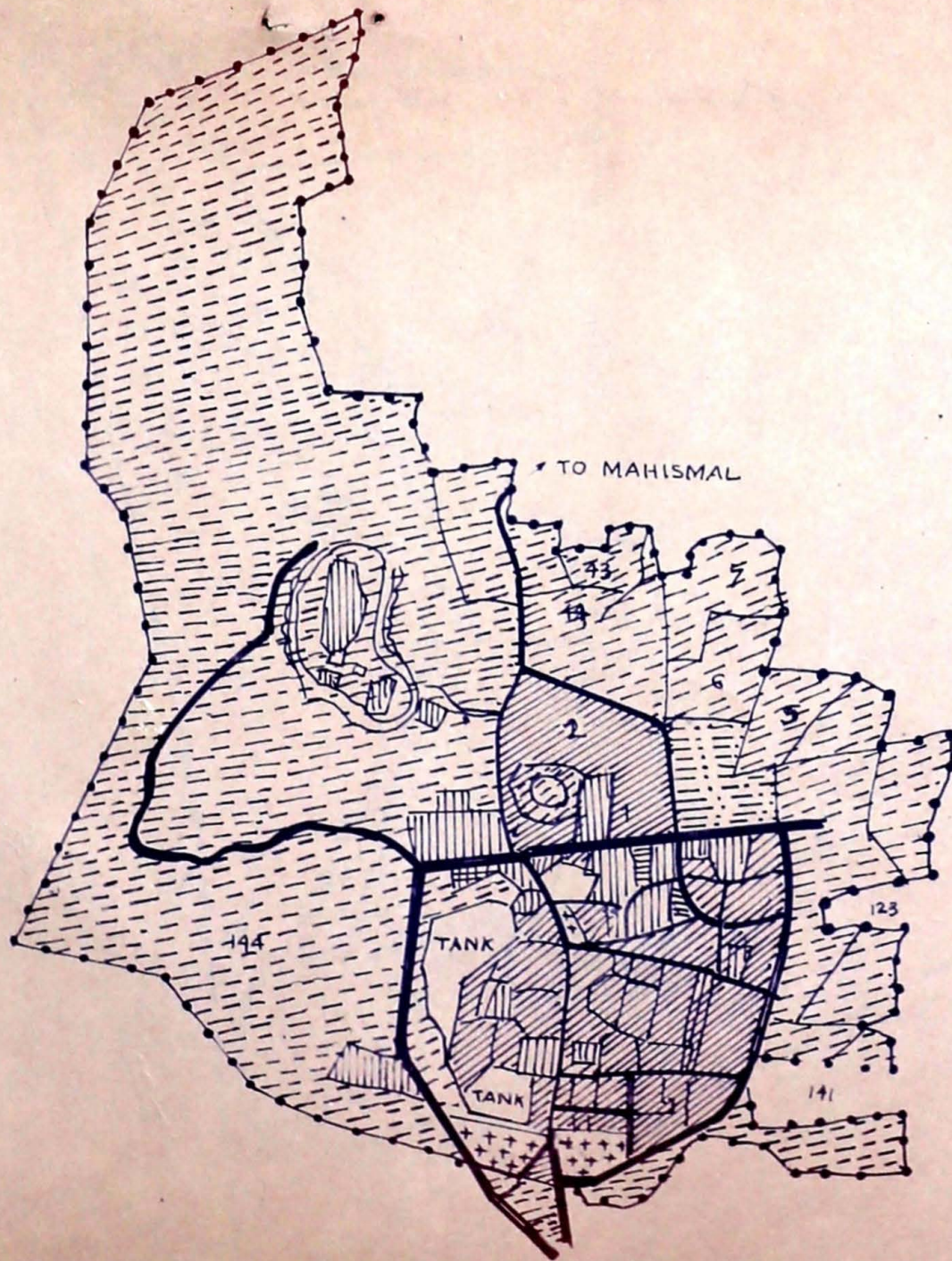

• **DEVELOPMENT PLAN**  
**OF KHULTABAD**  
proposed land use map

- references:
- residential 
- commercial 
- industrial 
- public & semipublic 
- public utility 
- transport 
- open space, garden 
- agricultural 
- water bodies 
- municipal limits 

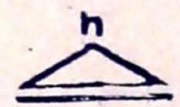

DEVELOPMENT PLAN SANCTIONED  
 VIDE U.D.P.H. & H.D. RESOLUTION NO TPS  
 3071/81694 - W-II DATED 20-3-1973  
 TO COME IN TO FORCE FROM 2-5-1973

TO AURANGABAD

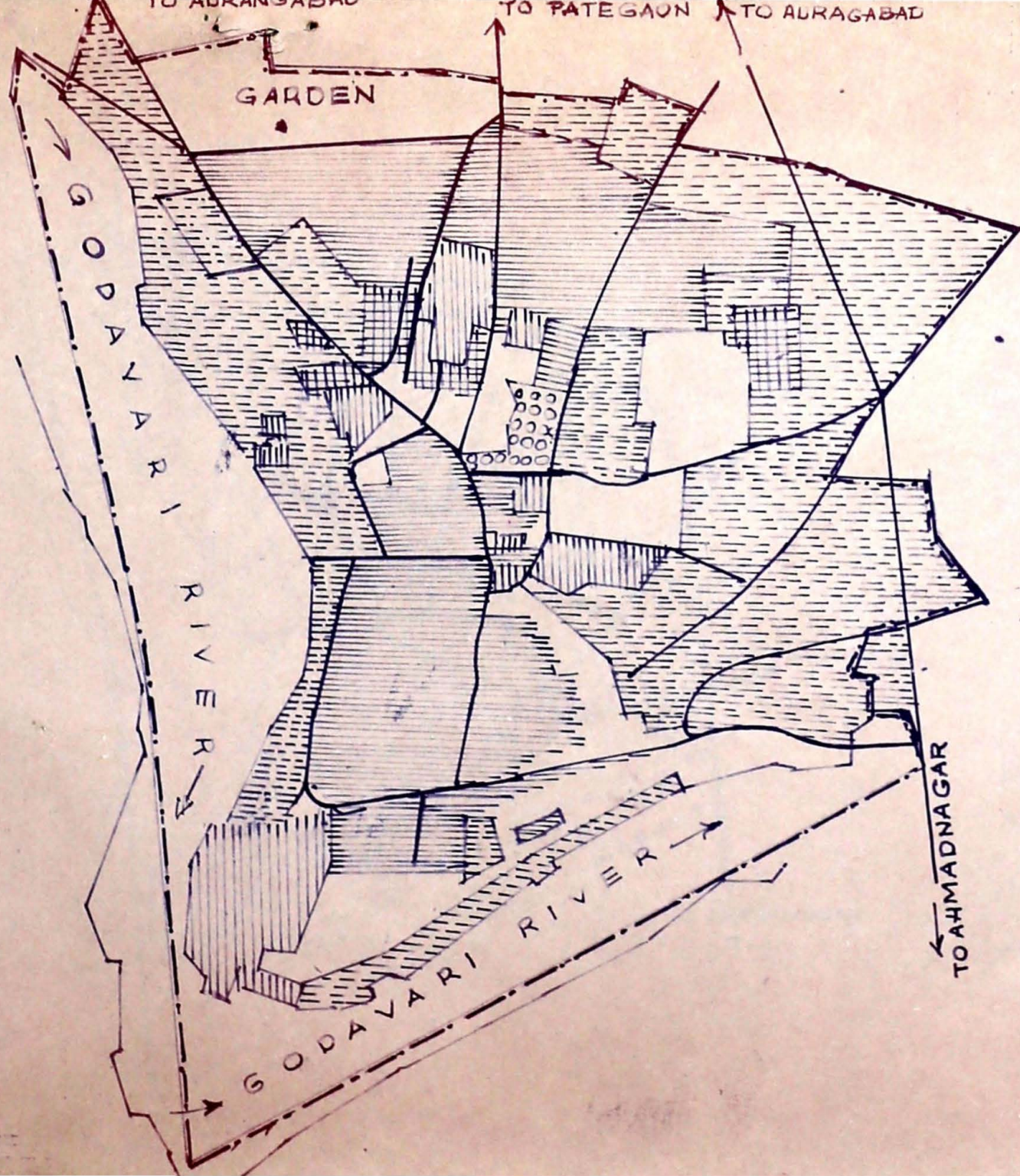

- DEVELOPMENT PLAN OF PAITHAN
- existing land use map
- references:
- residential
- commercial
- industrial
- public & semipublic
- public utility
- transport
- open space, garden
- agricultural
- water bodies
- municipal limits
- vacant land



DEVELOPMENT PLAN  
OF FAITHAN  
proposed land use map

• references :

- residential
- commercial
- industrial
- public & semipublic
- Kabrastan
- transport
- Public utility
- agricultural
- water bodies
- municipal limits

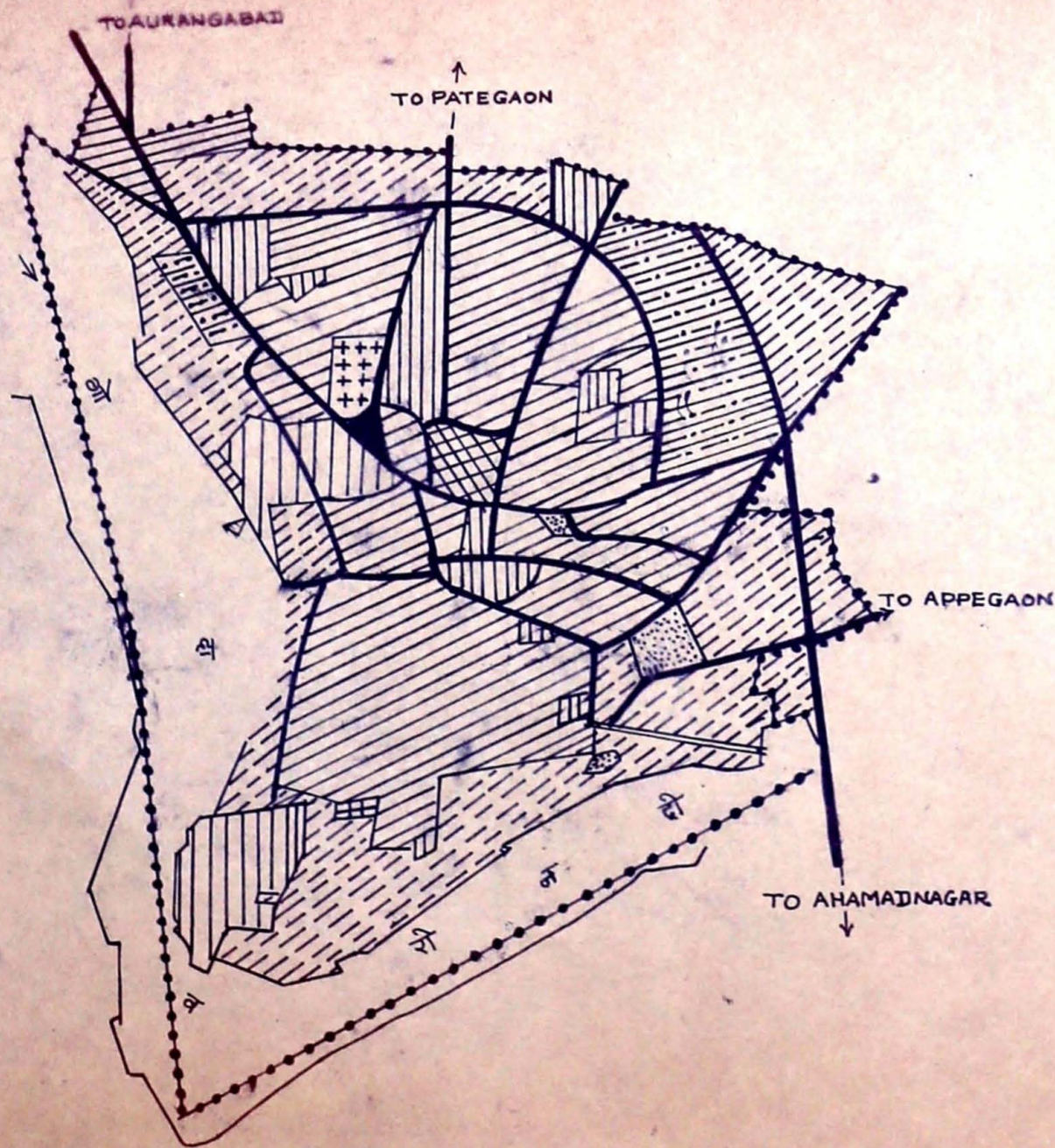

**NOTE:** DEVELOPMENT PLAN  
SANCTIONED VIDE U.D.P.H. &  
H.D. RESOLUTION NO. TPS/3071/  
2081/-W-II DATED 9-5-1972 TO  
COME INTO FORCE FROM -  
1-7-1972.

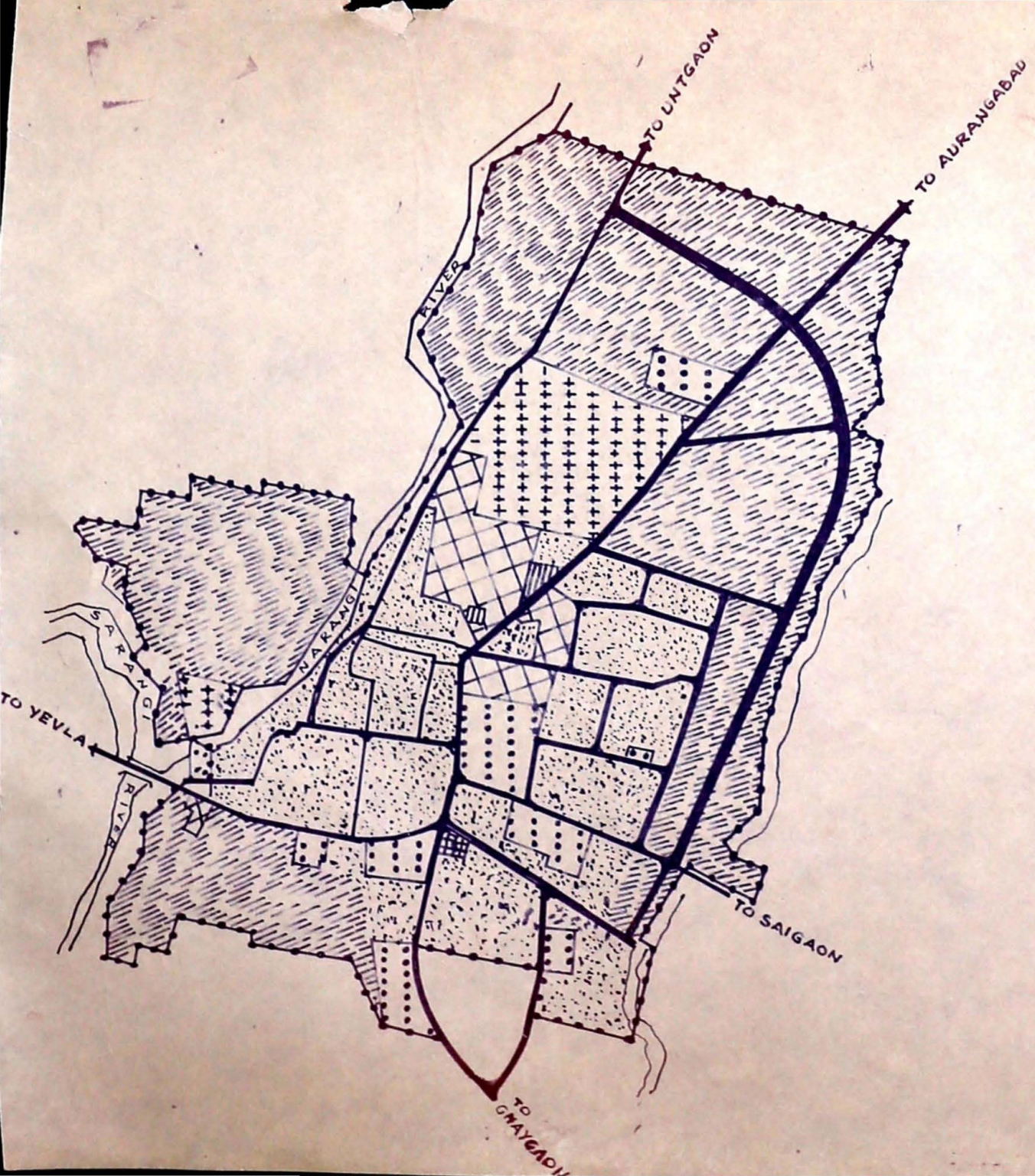

• **DEVELOPMENT PLAN**  
**OF VAJAPUR**  
 proposed land use map

- references:
- residential
  - commercial
  - industrial
  - public & semipublic
  - public utility
  - transport
  - open space, garden
  - agricultural
  - water bodies
  - municipal limits

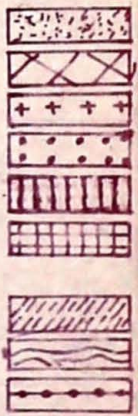

DEVELOPMENT PLAN SANCTIONED  
 VIDE U.D. & H. & H.D. RESOLUTION  
 No. T.P.S. 3073/41923-W-II-  
 DATED 21-3-1974 TO COME INTO  
 FORCE FROM 15-5-1974

TAX